

BUILDING FOR STUDENT WELL- BEING

Maria Weston Chapman
Middle School, Weymouth MA

Association for Learning Environments
LearningSCAPES 2024

Speakers:

Matthew Meehan, CEFP

Director of Facilities, Hingham MA Public Schools

James Liebman, AIA

Senior Associate, HMFH Architects



Introduction

Educational Visioning

Architectural Response

Educational Design



Student Well-being

Student well-being encompasses the **overall health** of a student, including their **social, mental, physical, and emotional health**.

Enjoyment and satisfaction with life are inextricably tied to student well-being.

In a nutshell, student well-being is the **way they perceive themselves and their life**.



Maria Weston Chapman Middle School

Weymouth, MA Public Schools

New construction (mostly)

Grades 6-8

1470 students (design capacity)

252,000 sf

Largest middle school in MA

Opened 2022

TOWN OF WEYMOUTH, MASSACHUSETTS
SCHOOL BUILDING COMMITTEE



Do you Have a
Vision
for
A New
Chapman
School??

 **We need YOU!** 

Dear Teachers, staff, administrators, parents, students, and community members,

Be a part of our Feasibility Study Visioning Team who will come together with our professional education consultants to develop a strong and lasting learning and facilities vision at our New Chapman Middle School!

We're looking for 30-40 members who are available on the three dates below to meet to discuss educational goals, how learning is being delivered, our strengths, our weaknesses, our opportunities, programmatic relationships, conceptual organization, impact of architecture, and several other topics that will help us shape the Educational Plan for a New Chapman Middle School.

Visioning Meeting Dates: **Tuesday, October 3, 2017 (up to four hours)**
 Tuesday, October 17, 2017 (up to four hours)
 Monday, October 30, 2017 (about two hours)

All meetings will start at 6:00pm and be held at the MJI, Humanities Center at WHS. To make this process most effective, it is important that you attend all three meetings.

If you would like to be a part of the Chapman Visioning Team, please send an email to schoolbuildingcommittee@weymouth.ma.us with your name, email, phone number, and a brief statement as to why you wish to be on this committee. Thank you!

75 Middle Street, Weymouth, MA 02189



Chapman Middle School

Our Students

1198



54.5% High Needs

39.7% Low Income

23.7% Students with Disabilities



18.2% First language not English

6.3 % ELL

30 countries represented by students

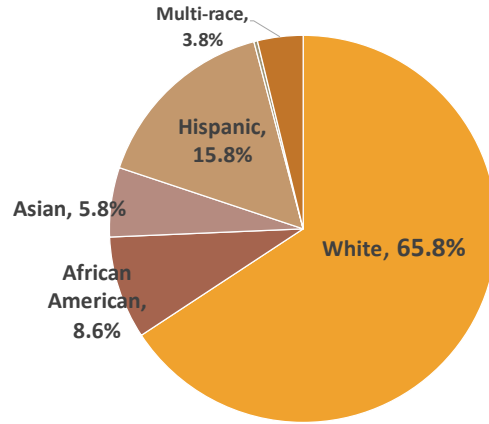

16

Number of **Exploratory** courses 6th grade students explore

26

Number of elective and lab courses 7 & 8 students can choose from

Our Staff

200 Staff

23 ESP

94 Teachers

15 Counselors

30 Special Education

6 Administrators

Athletics-Clubs

Track and Field

Cross Country

Theater Club

Volleyball

Musical Club

Basketball

Media Club

Wrestling

Our School Profile

Scan the QR code to find out about all of our school's data and information or call the school! You can also call the main office!



Project Opens Opportunities for the District

- From a Primary Model to ½ K-4 to an **K-5 Elementary Model**
- Connects Middle School **Labs to CTE** experiences at the HS
- Expands Learning **Beyond the Core** at the Middle School Level
- Expands Hands on and **Project Based learning**
- Provides for an Equitable Experience



- Increased focus on **student wellbeing** through spaces and new course selections

Educational Visioning

Visioning

Goal Setting

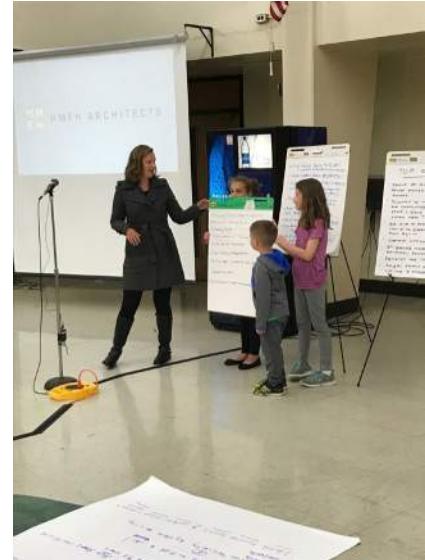

Visioning

Educational Goals

The new school should support:

- student collaboration and teacher collaboration
- engaging and empowering the student through interdisciplinary, project-based STEAM activities and through Fine and Performing Arts activities
- curiosity and desire for life-long learning
- student health and student social and emotional growth
- building responsibility for self, community, and greater society
- be a model for equity and accessibility



Visioning

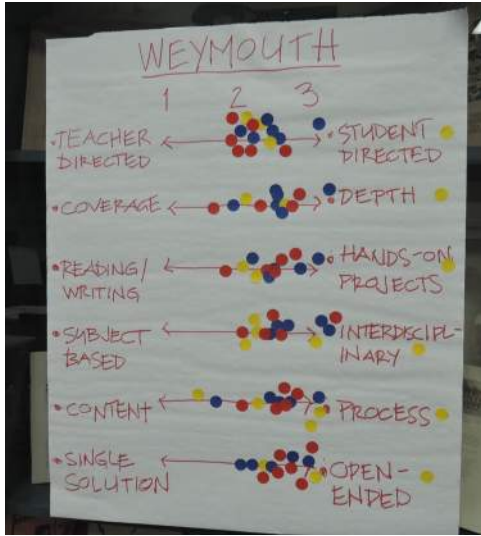

Current Perceptions

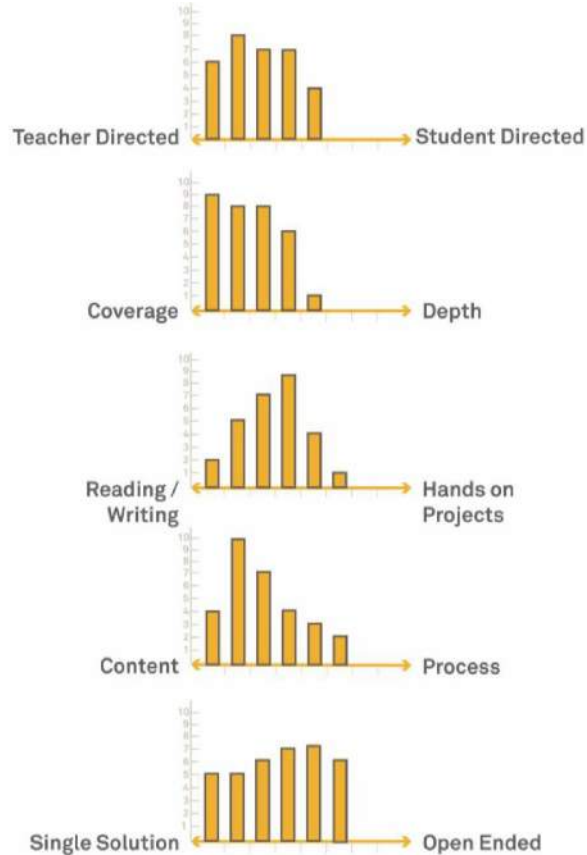

Future Direction

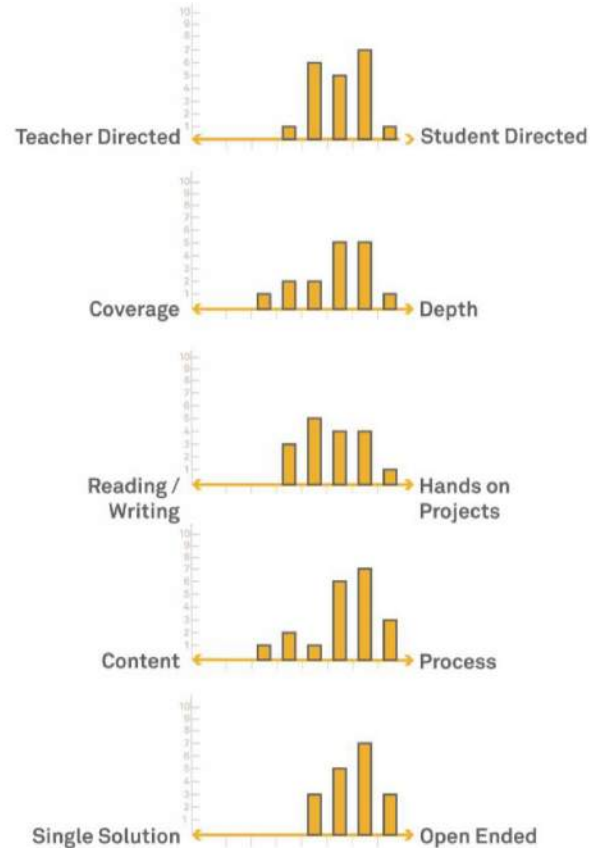

Visioning

Cluster made up of teams around support spaces

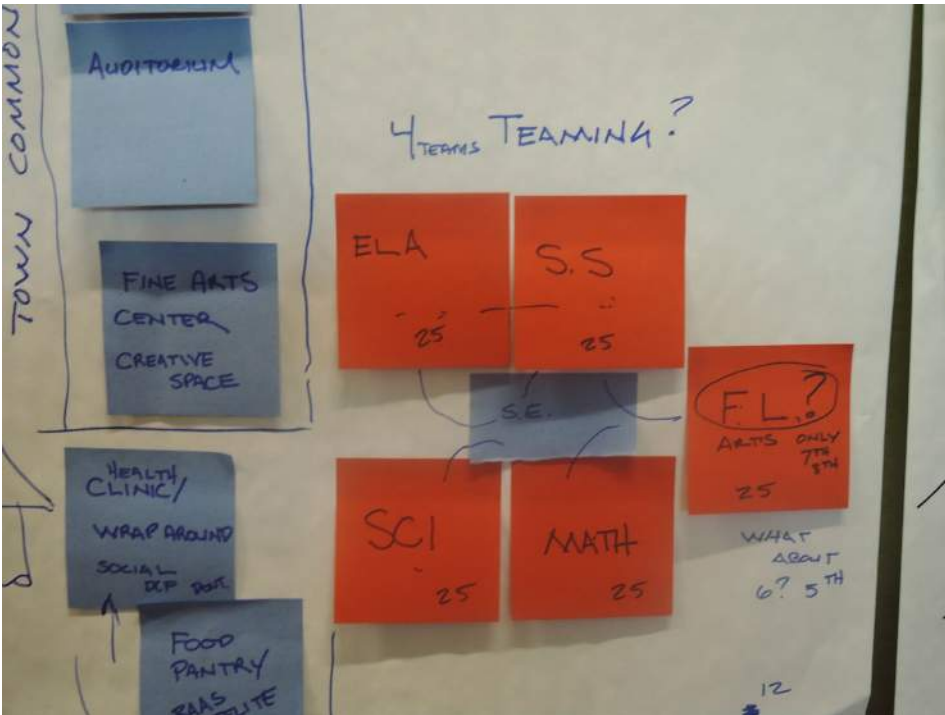

Visioning

'TOWN SQUARE' MODEL

Communal Realm

Cohort Realm

EXPLORATORY LABS

Prominence

Unique Identity

Transparency

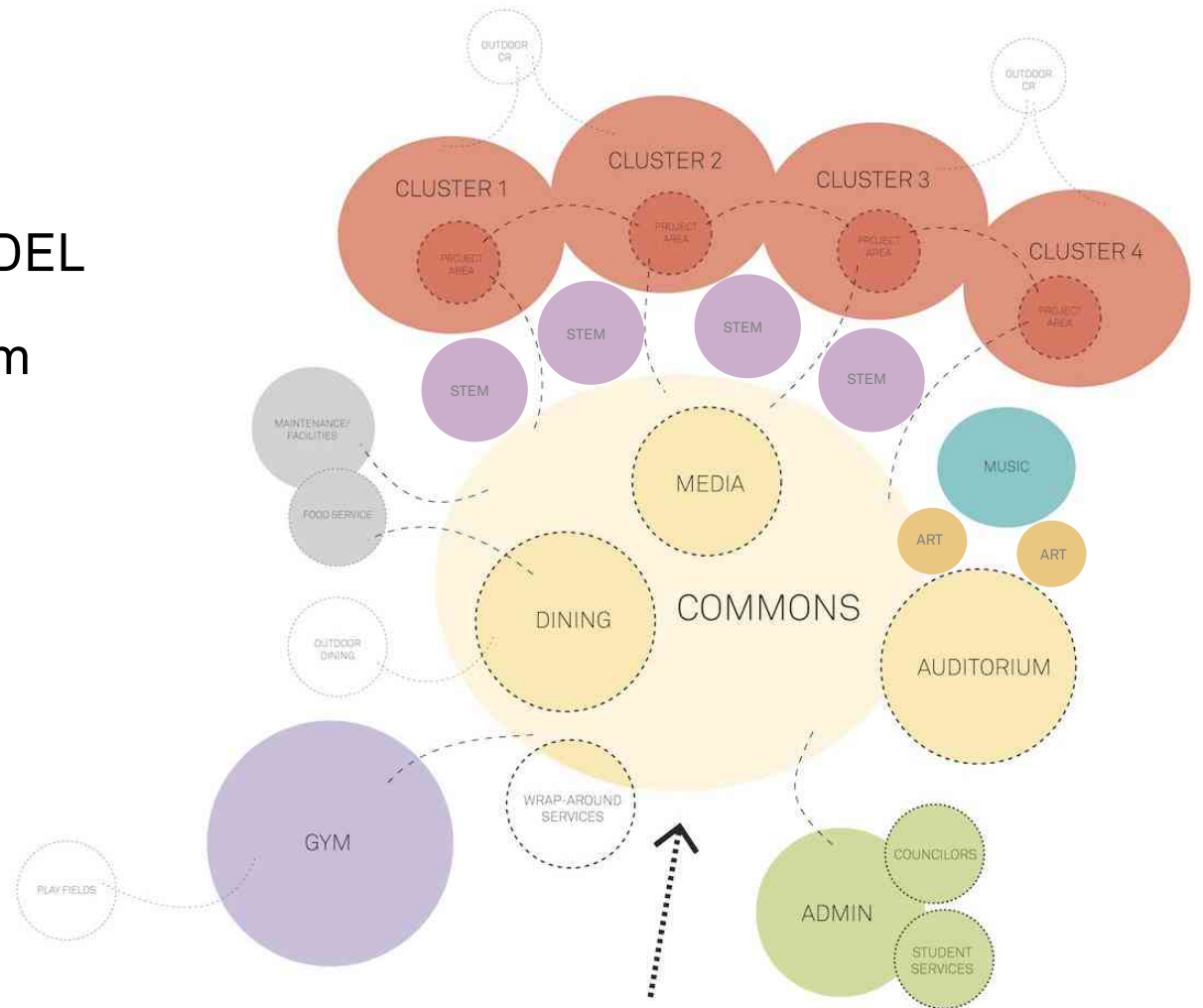

Academic Groupings

COHORT REALM

Grade - Wing

Neighborhood - Floor

Team - Cluster

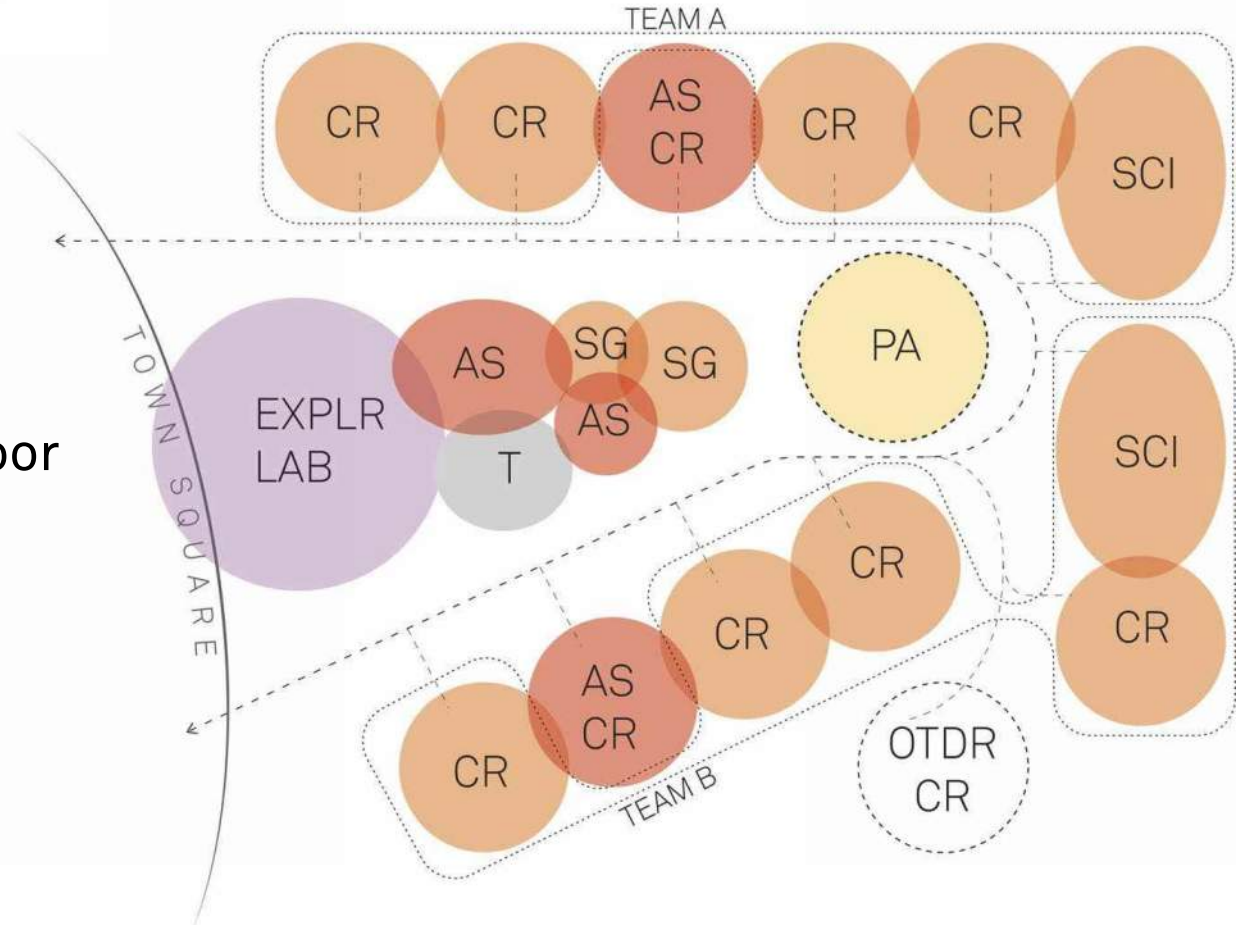

Feature Labs

Culinary Lab

Expeditionary Lab

Theater Arts Lab

Broadcast Media Lab

Media Center

Maker Lab

Fabrication Lab

Neighborhood Collaborative Areas

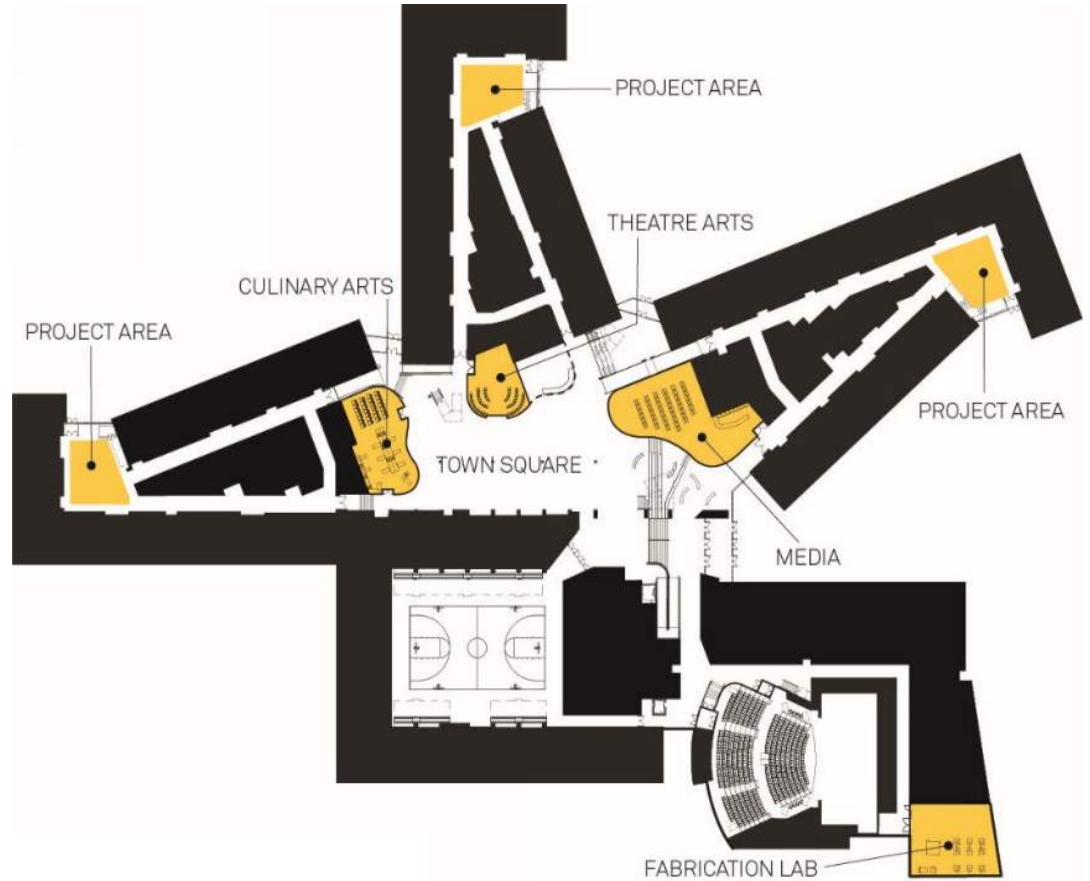

Career Technical Education in MA

 The Department has moved to 135 Santilli Highway in Everett. The Department's office and Licensure Welcome Center are open. The new location has free parking and is a short walk from the Wellington station on the MBTA's Orange Line.



Most
Requested:

Licensure

Learning
Standards

MCAS

Educator
Evaluation



Career Technical Education

Information for Families

Admissions

After Dark Programs

Advisory Committees

Student Organizations

Chapter 74 Programs

Chapter 74 Programs

Chapter 74-approved vocational technical education programs are programs that meet the definition of vocational technical education contained in Massachusetts General Law Chapter 74. Districts apply for program approval to DESE's Office for College, Career, and Technical Education (OCCTE) pursuant to Chapter 74 and the Vocational Technical Education Regulations. Note that all Chapter 74-approved vocational technical education programs meet the Perkins Act definition of career and technical education. Chapter 74 programs are considered by the Department to be [High Quality College and Career Pathways](#).

For School Districts considering applying for new Chapter 74 programs, see resources at [Massachusetts Chapter Program Application](#) page.

- [Massachusetts School Finder](#)



Connecting to High School CTE

Chapman Middle School

Weymouth High School

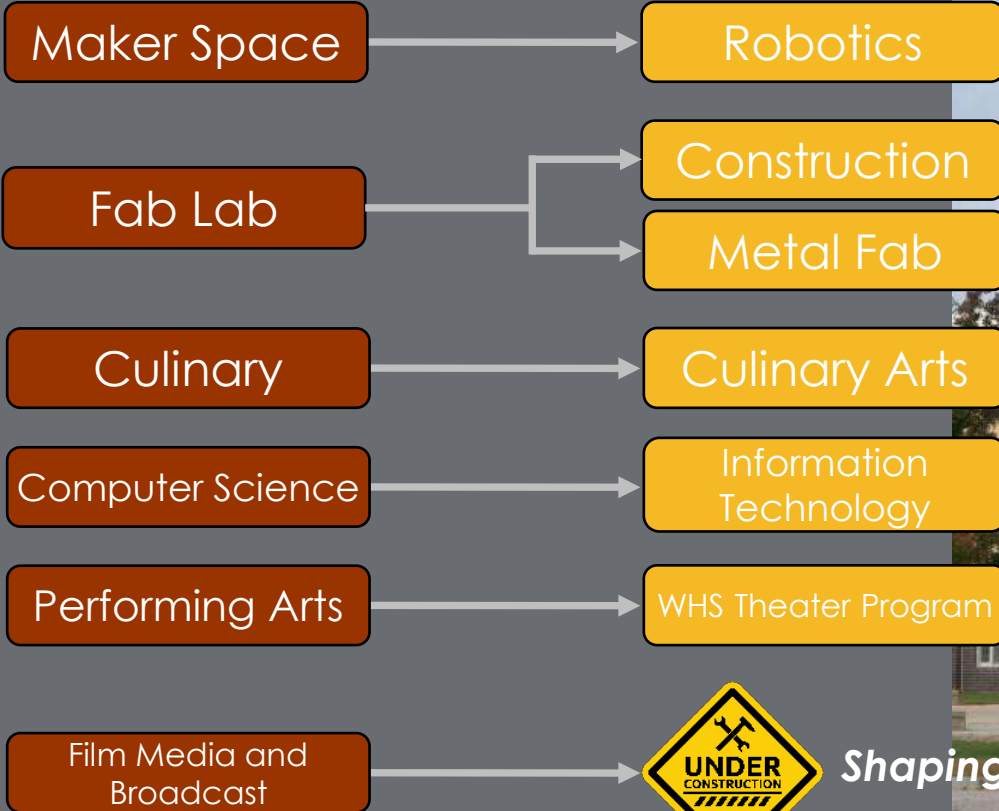

Shaping the Future

Architectural Response

Organizational Drivers

The Site



Organizational Drivers

Gymnasium Reuse

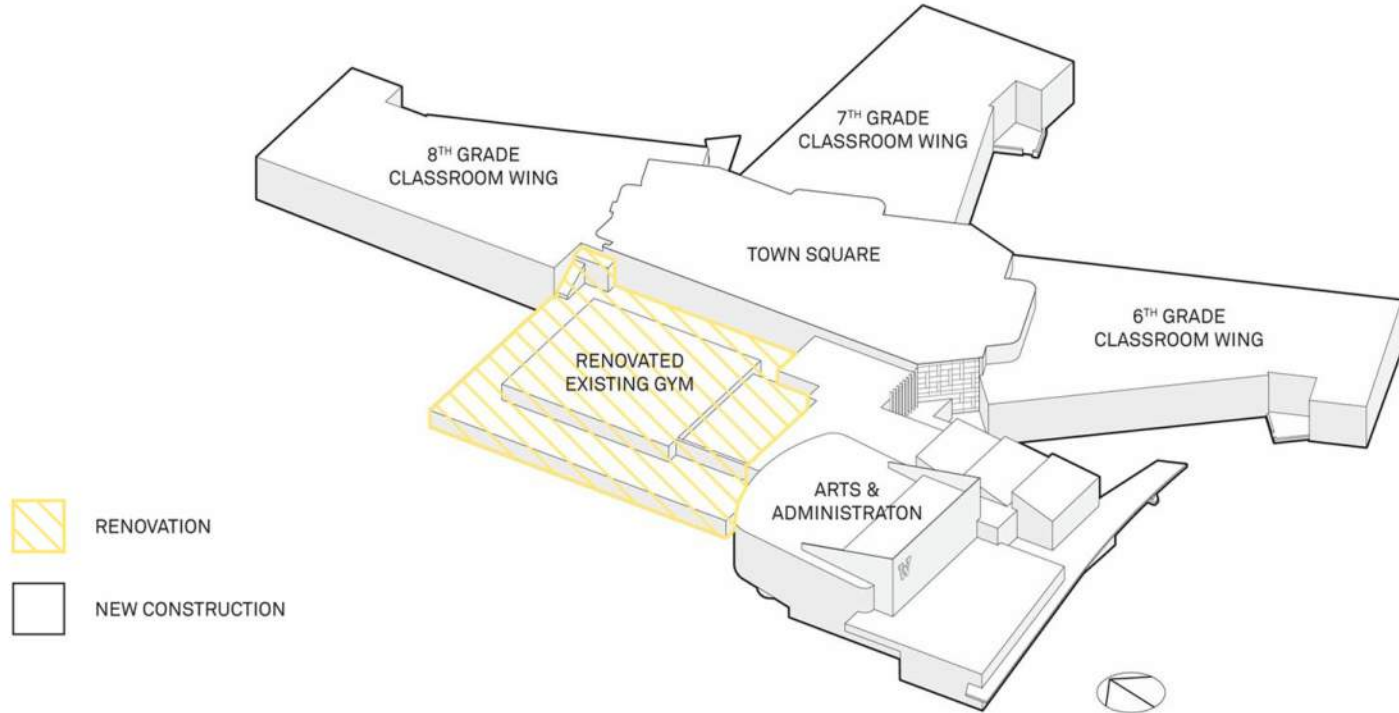

Lab Containers

Pods

SPECIALTY LABS

- 1 CULINARY ARTS
- 2 EXPEDITIONARY LAB
- 3 THEATER ARTS
- 4 BROADCAST
- 5 MEDIA CENTER
- 6 MAKER SPACE

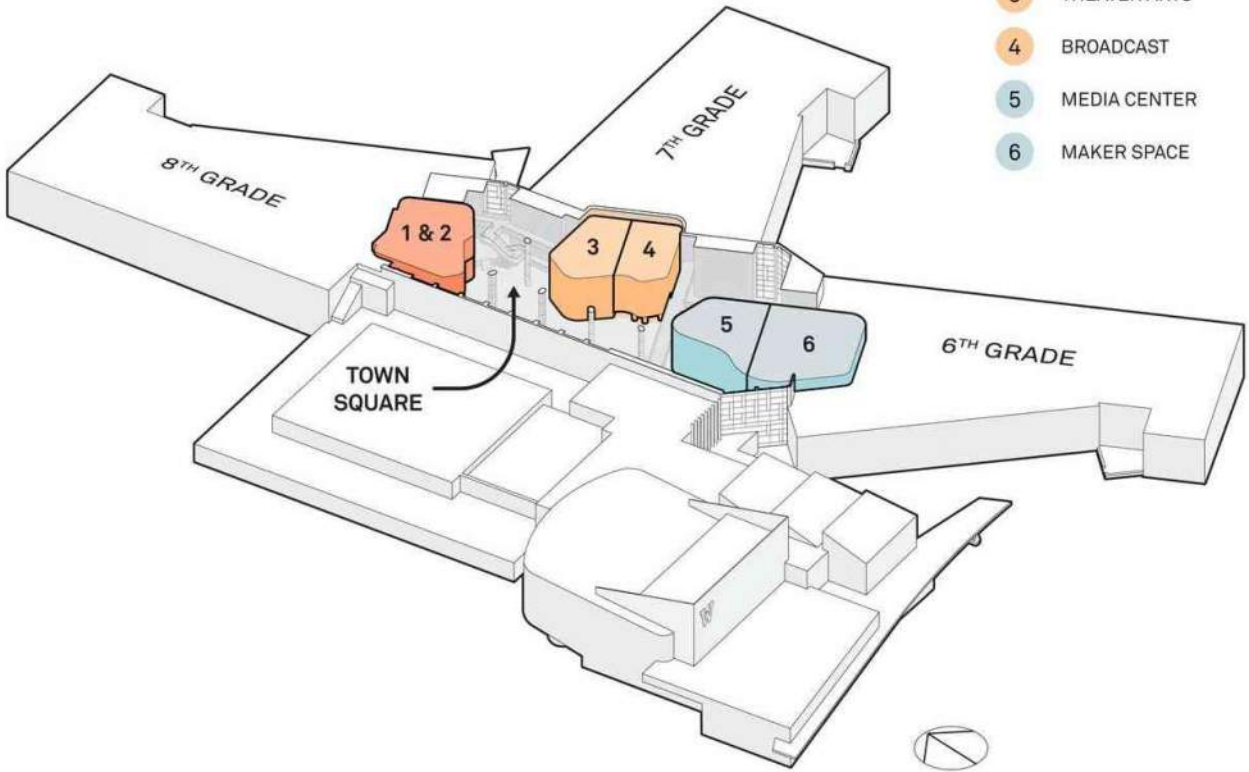

Town Square



Town Square



Pod Identity

Cladding

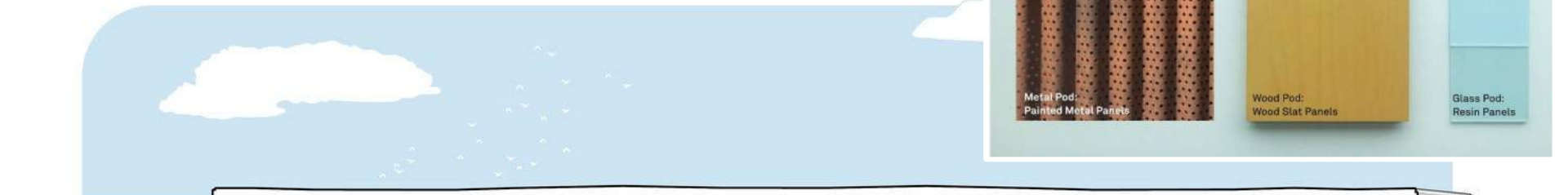

Culinary Arts & Expeditionary Lab

Theater Arts & Broadcasting

Media Center & Maker Space

Glass Pod



Glass Pod



MEDIA CENTER & MAKER SPACE

- 1 Media center
- 2 Media classroom
- 3 Maker space

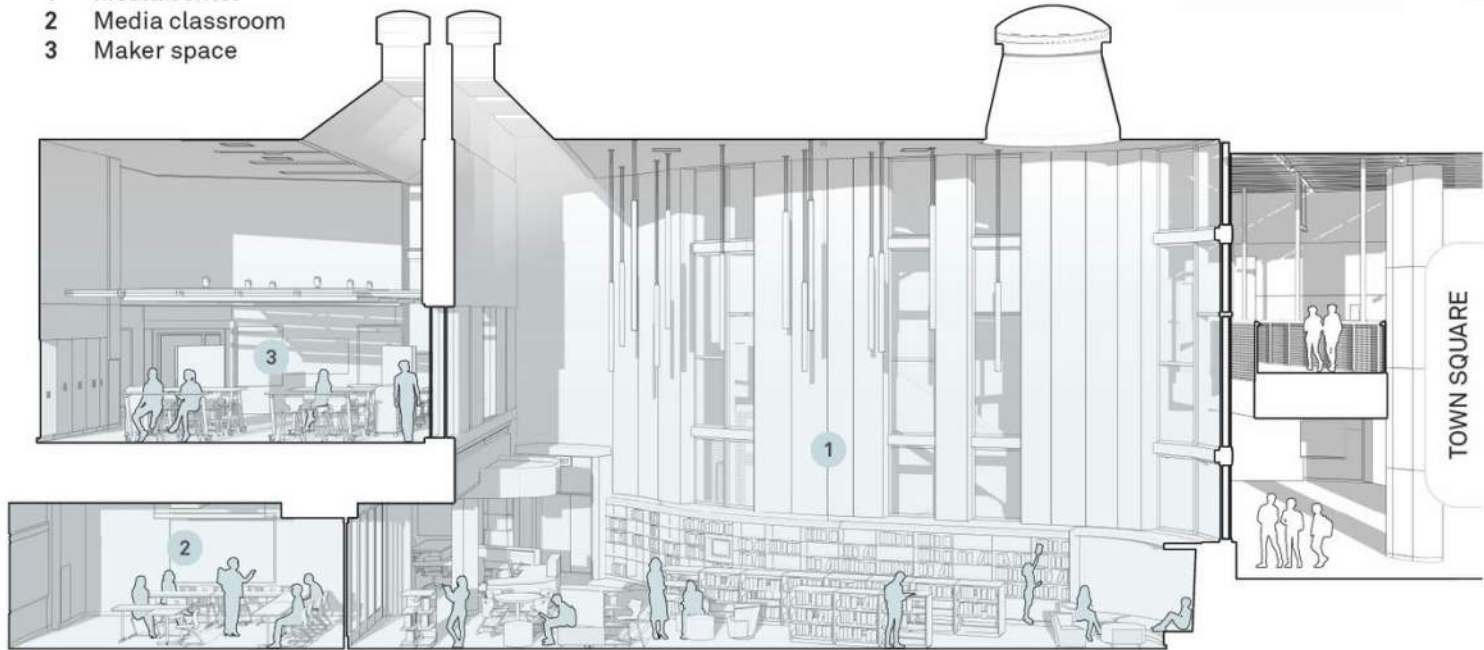

Glass Pod

Media Center & Maker Lab



Maker Lab

Intro Course - Lab Safety
and Maker Tools

Automation and Robotics

Design and Modeling

Medical Detectives

Energy and the Environment



Media Lab

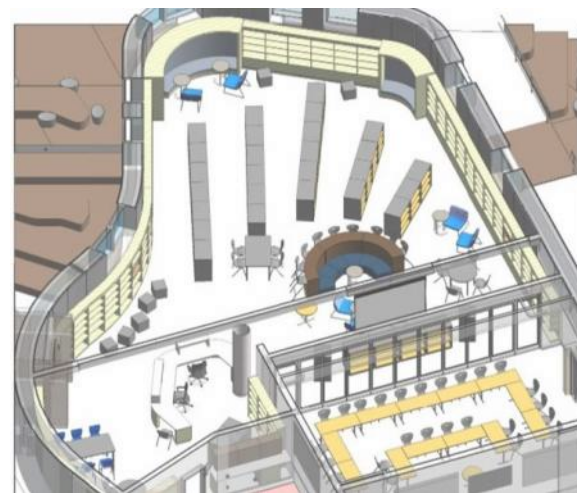

Wood Pod



Wood Pod

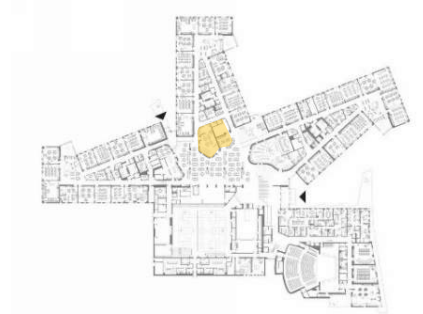

THEATER ARTS & BROADCASTING

- 1 Broadcast studio
- 2 Control room
- 3 Tension-wire grid
- 4 Theater arts classroom



Wood Pod

Theater Arts & Broadcast Lab

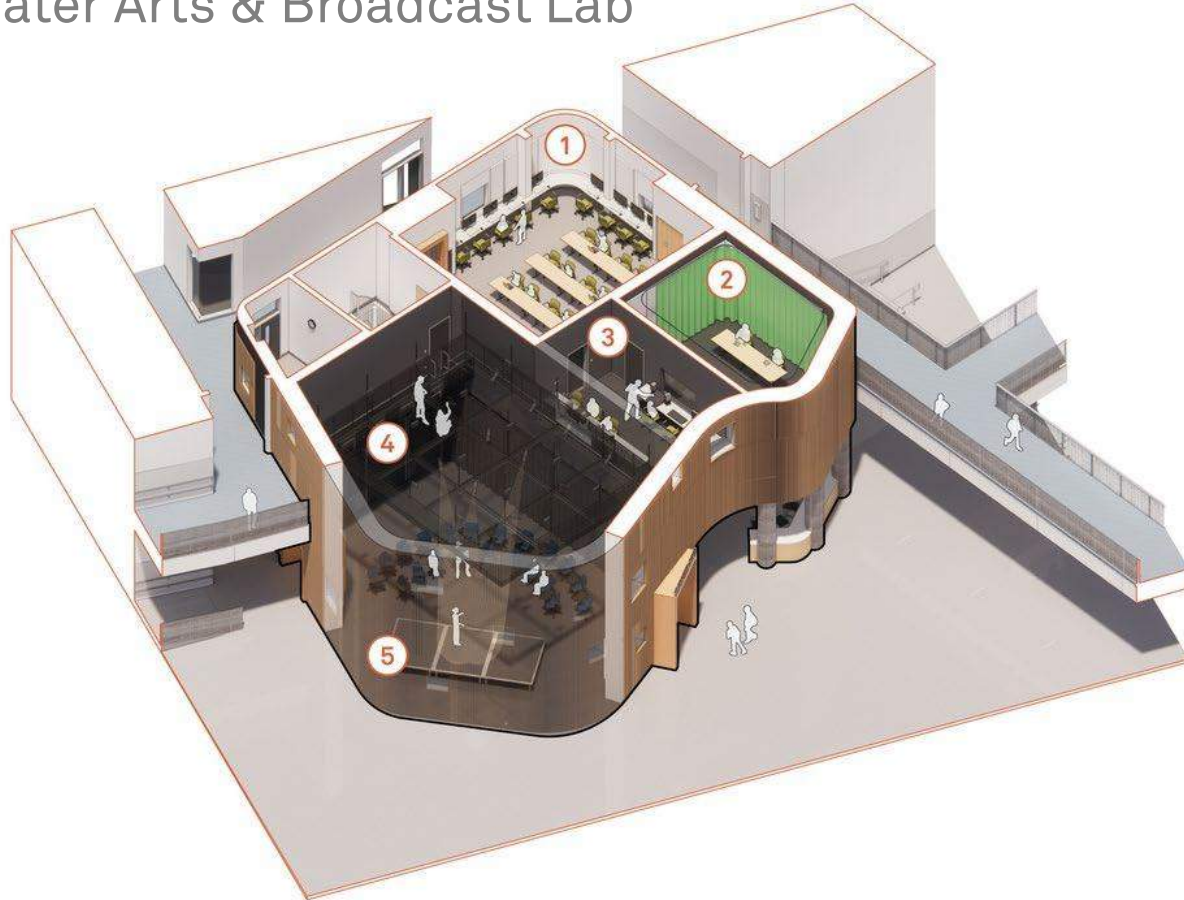

- 1 BROADCAST CLASSROOM
- 2 BROADCAST STUDIO
- 3 CONTROL / LIGHTING
- 4 TENSION WIRE GRID
- 5 BLACK BOX THEATER

Film Media & Broadcasting Lab

Introduction to
Communications

Film Video and Media I, II

Broadcast Studio*
(Lighting, Sound and Set Design)

Chapman Chops*

* in development



Theater Arts

Black box theater

Intro to Theater Arts

Acting I, II

Script Writing

Costuming

Choreography

Stage Design and Scenography

Technical Theater

(Lighting and Sound Design)



Theater Arts

Black box theater



Metal Pod



Metal Pod

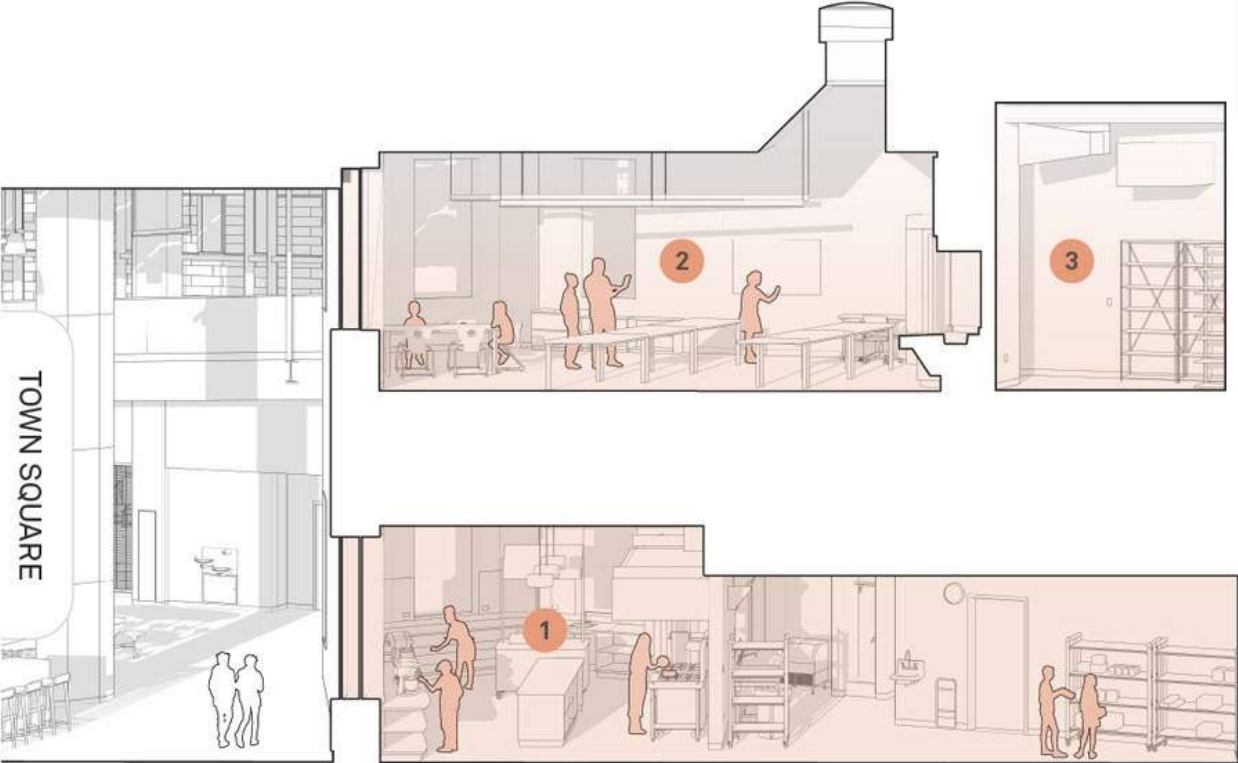

CULINARY ARTS & EXPEDITIONARY LAB

- 1 Culinary arts
- 2 Expeditionary lab
- 3 Storage

Culinary

Three spaces in one

Funding Line

Connected with
Cafeteria Vendors

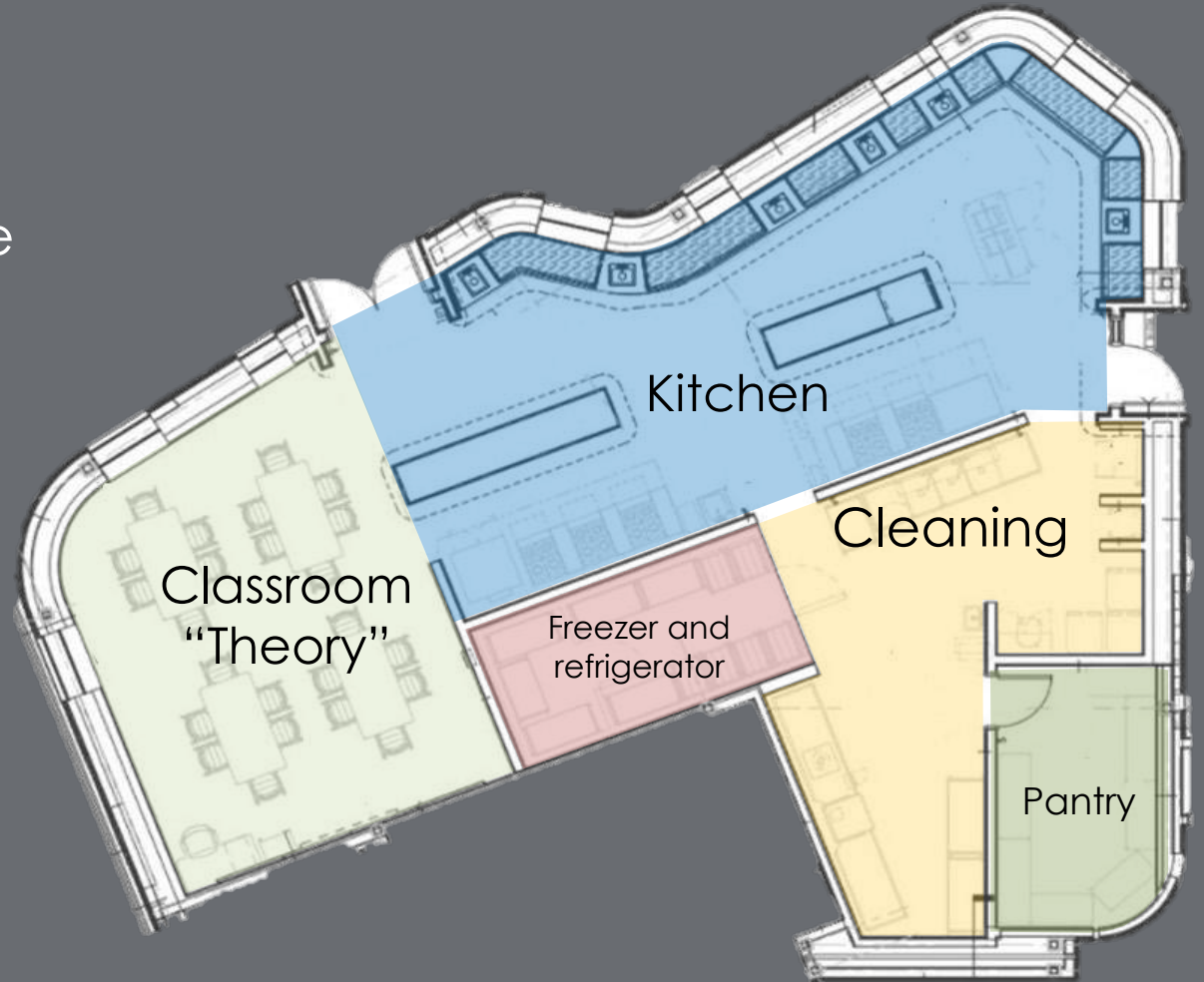

Culinary

Intro Course: Food
Science and Safety

Cultural Connections

Farm to Table

Chapman Chops!

Catering Club



Expeditionary Learning Lab

Intro to PBL

Community Journalism

Urban Design

World Of Change

Screen Writing and
Production



Performing Arts

Chorus 6,7,8

Select Chorus

Music Appreciation

Music Technology I,II

Guitar I,II

Instrumental Music 6,7,8

Select Band

Piano I,II

Modern Band I,II



Performing Arts Theater



Fab Lab

Intro Course – Lab Safety

Wood Framing

Wood and Metal
Fabrication

Green Architecture

Stage Design, Scenography



Fabrication Lab



Health, Wellness and Physical Education

Six sections

Health 6

PE 6

Team Sports

Adventure and Obstacle
Course

Lifetime Sports

Cardio Sport

Movement and Expression

Mindful Moments

CrossFit Training

Health and Wellness

Nutrition

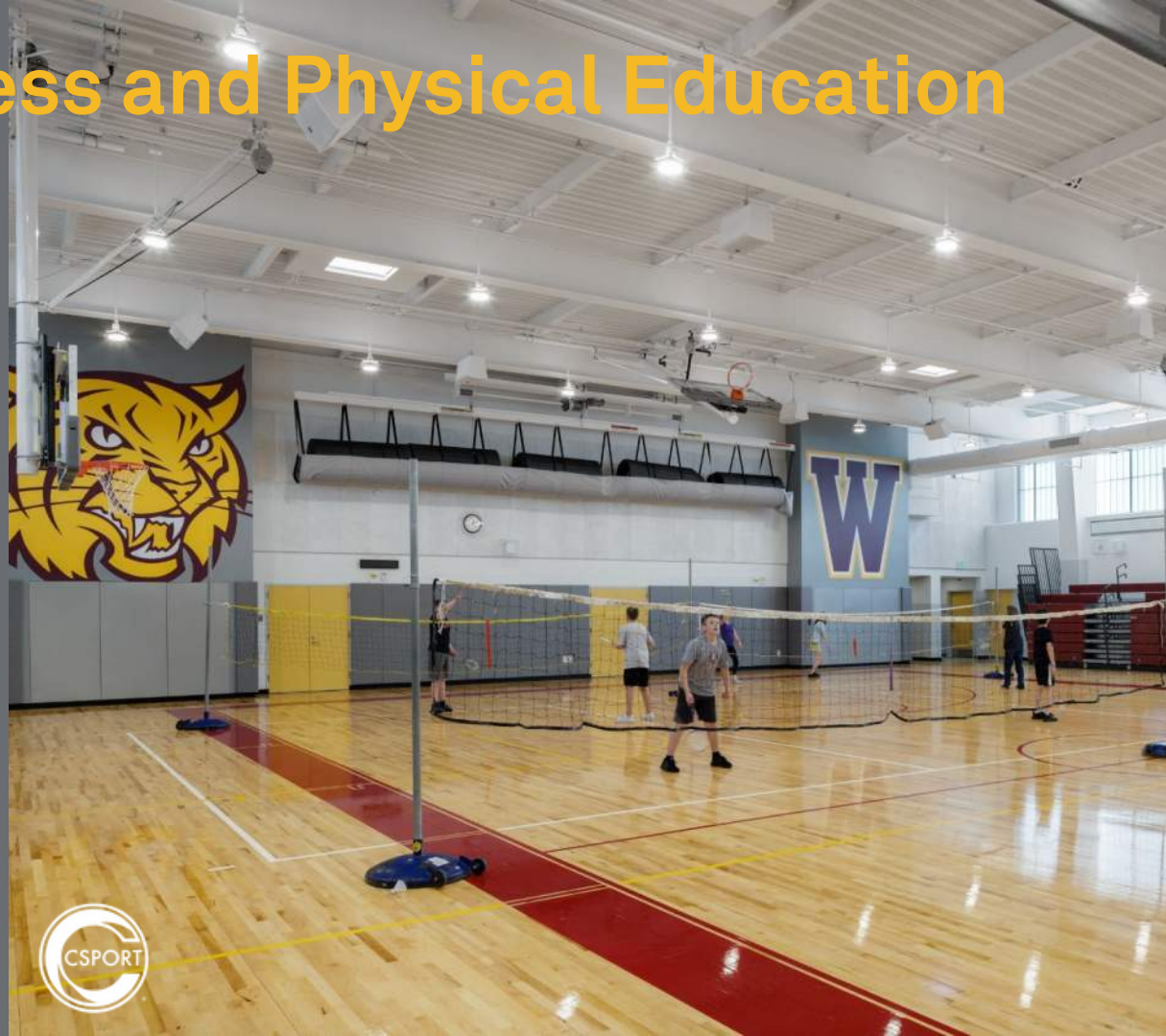

Studio Arts

Intro to Visual Art

Graphic Arts*

Photography*

3D Art and Sculpture

Painting

Ceramics

Sketching

Advanced Art Studio

* in development

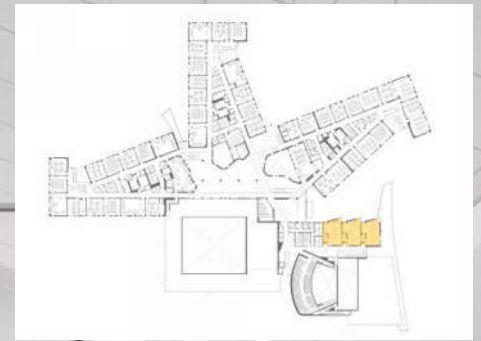

Core Labs

A second dose

Math Lab

Accelerated Math Lab

Reading Lab

Writing Lab

Geography Lab

Science and Technology



Neighborhood Collaborative Areas



Neighborhood Collaborative Areas





Educational Design

Exploratory

vs.

Elective

All students engage in exploring all labs and courses so they can be **exposed** to as many different learning opportunities outside of the core. The intention is to spark interest where it may not have been before.

Grade 6

All students engage in **choosing** courses based on their interest. The purpose of the electives is for students to dive deeper into subject matter which infuses them with a rich, in depth, standards based learning experience.

Grades 7 and 8

How we expanded opportunities

The master schedule

The Core



Electives 7,8



Exploratory 6



How we expanded opportunities

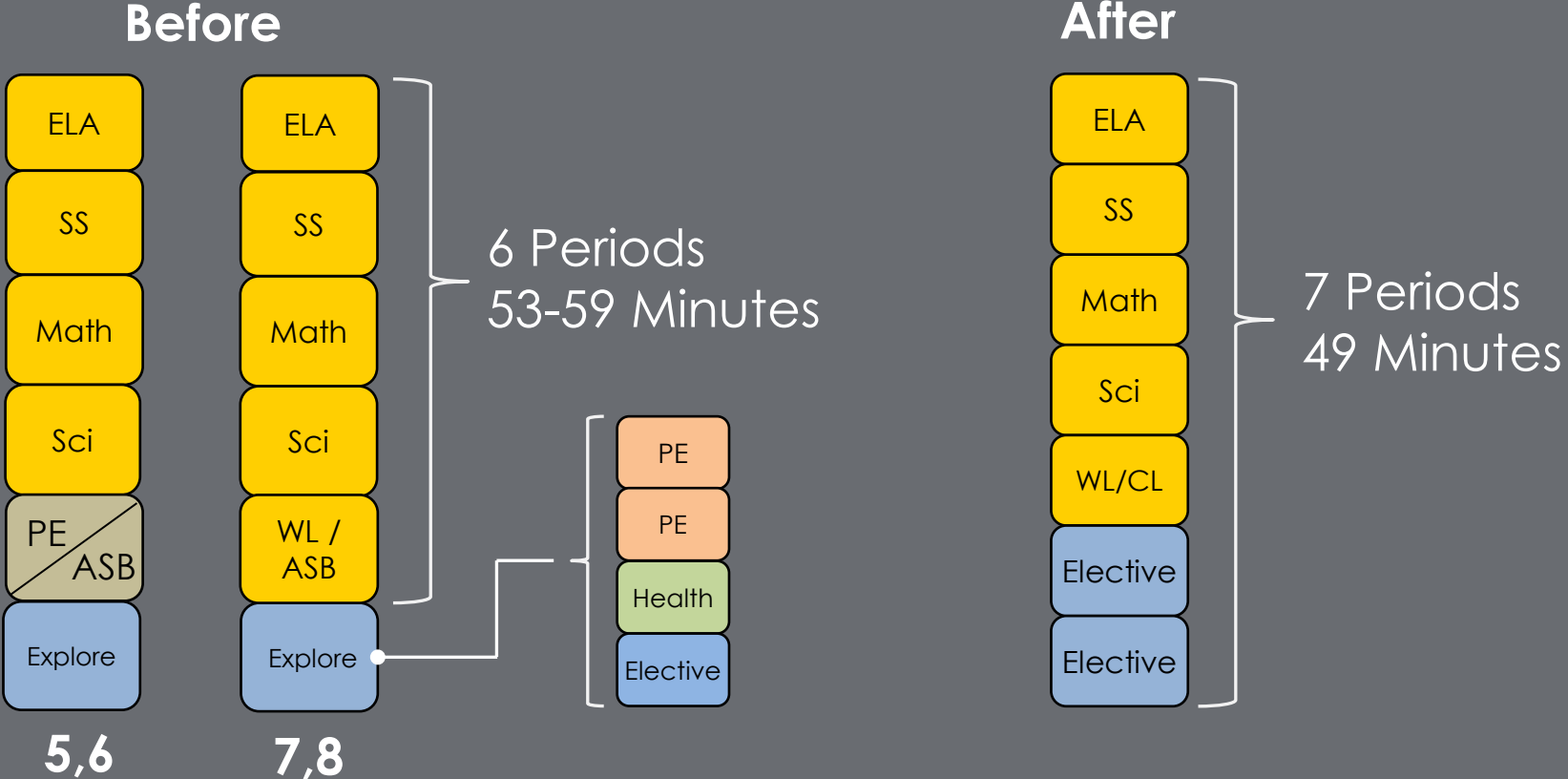

How we expanded opportunities

6 x 7 day cycle

MWC Rotation
2022-2023

Period	Day	1	2	3	4	5	6
1	1st Period 8:20 - 9:09 (49 minutes)	A	B	C	D	E	F
2	2nd Period 9:11 - 10:00 (49 minutes)	B	C	D	E	F	G
3	3rd Period 10:02 - 10:51 (49 minutes)	C	D	E	F	G	A
4	4th Period 10:53 - 12:14 (79 minutes)	D	E	F	G	A	B
	3 Lunch Cycles						
5	5th Period 12:14 - 1:03 (49 minutes)	E	F	G	A	B	C
6	6th Period 1:05 - 1:54 (49 minutes)	F	G	A	B	C	D
7	7th Period 1:56 - 2:45 (49 minutes)	G	A	B	C	D	E

Odd
Days

How we expanded opportunities

6 x 7 day cycle

MWC Rotation
2022-2023

Period	Day	1	2	3	4	5	6
1	1st Period 8:20 - 9:09 (49 minutes)	A	B	C	D	E	F
2	2nd Period 9:11 - 10:00 (49 minutes)	B	C	D	E	F	G
3	3rd Period 10:02 - 10:51 (49 minutes)	C	D	E	F	G	A
4	4th Period 10:53 - 12:14 (79 minutes) 3 Lunch Cycles	D	E	F	G	A	B
5	5th Period 12:14 - 1:03 (49 minutes)	E	F	G	A	B	C
6	6th Period 1:05 - 1:54 (49 minutes)	F	G	A	B	C	D
7	7th Period 1:56 - 2:45 (49 minutes)	G	A	B	C	D	E

Even
Days

How we do it – 6 x 7 Day Cycle

Exploratories – 6th grade

Term 1

Odd days	Exploratory	Exploratory					
Even days	Exploratory	Exploratory					

Term 2

Odd days	Exploratory	Exploratory					
Even days	Exploratory	Exploratory					

Term 3

Odd days	Exploratory	Exploratory					
Even days	Exploratory	Exploratory					

Term 4

Odd days	Exploratory	Exploratory					
Even days	Exploratory	Exploratory					

16

Electives – 7th & 8th grade

Semester 1

Odd days	Elective	Elective					
Even days	Elective	Elective					

Semester 2

Odd days	Elective	Elective					
Even days	Elective	Elective					

Grade level movement

Making space for collaboration

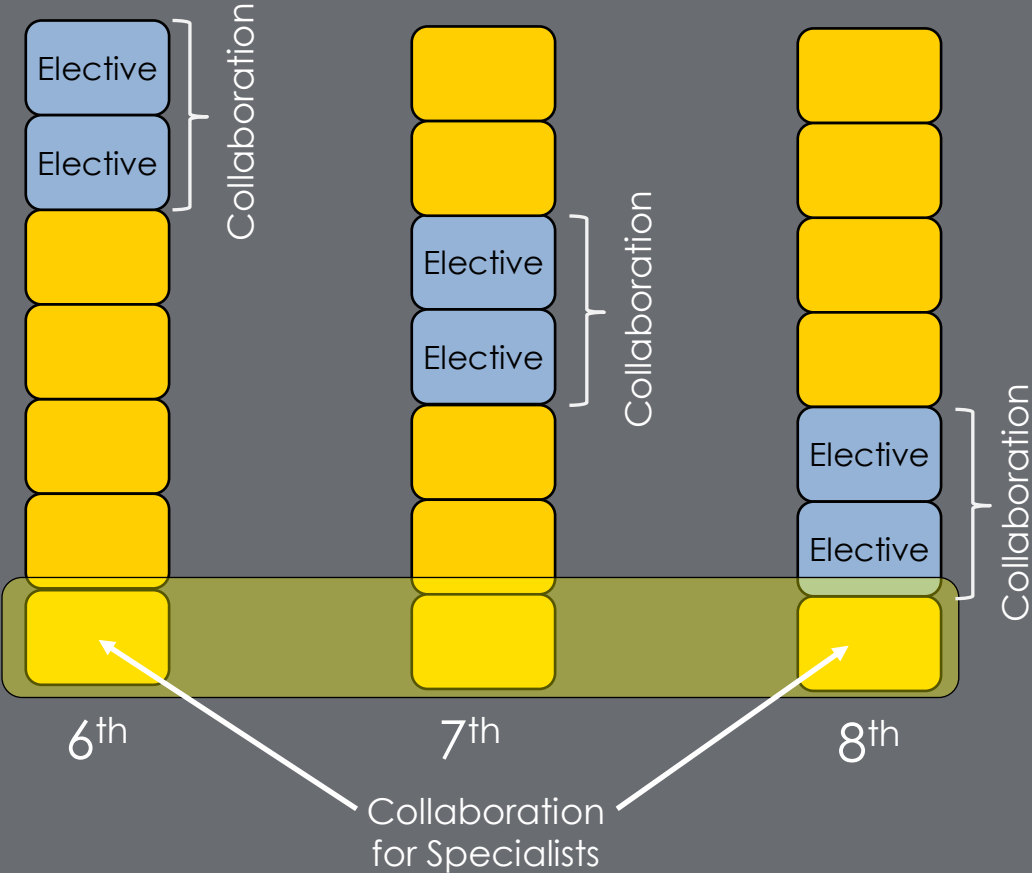

Stepped schedule

MWC Rotation
2022-2023

Period	Day	1	2	3	4	5	6
1	1st Period 8:20 - 9:09 (49 minutes)	A	B	C	D	E	F
2	2nd Period 9:11 - 10:00 (49 minutes)	B	C	D	E	F	G
3	3rd Period 10:02 - 10:51 (49 minutes)	C	D	E	F	G	A
4	4th Period 10:53 - 12:14 (79 minutes) 3 Lunch Cycles	D	E	F	G	A	B
5	5th Period 12:14 - 1:03 (49 minutes)	E	F	G	A	B	C
6	6th Period 1:05 - 1:54 (49 minutes)	F	G	A	B	C	D
7	7th Period 1:56 - 2:45 (49 minutes)	G	A	B	C	D	E

How we do it

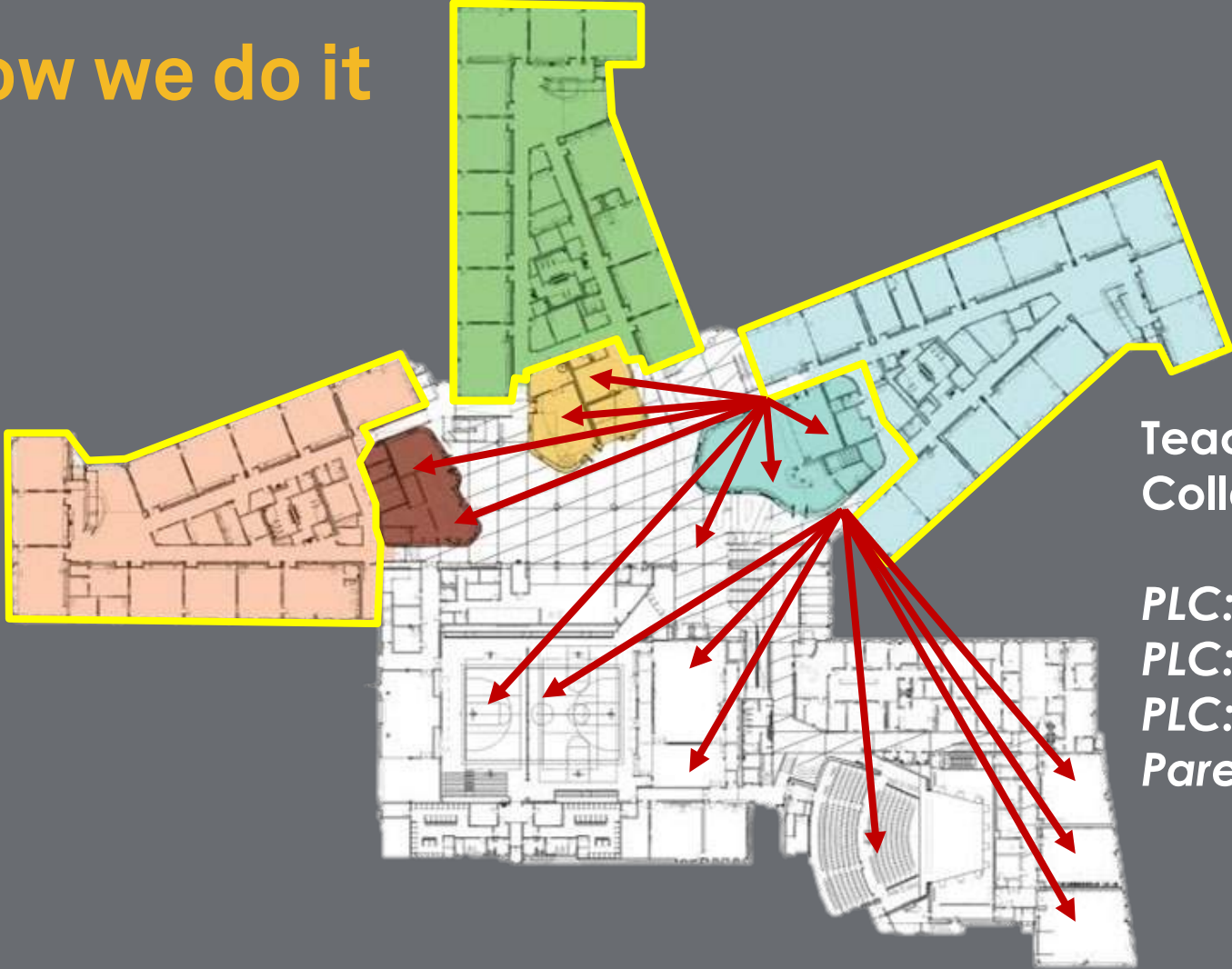

**Teacher
Collaboration**

- PLC: PBL*
- PLC: Content*
- PLC: Team*
- Parent Meetings*

Master schedule

Lab	Courses	Semester		Semester 1															
		Term	1	2	1							2							
		Day	1	2	3	4	5	6	7	1	2	3	4	5	6	7			
Maker Space	Introduction to Maker Space 6	Block A	6	6	6	6	6	6	6	6	6	6	6	6	6	6	6	6	6
	Introduction to Maker Space 6	Block B	6	6	6	6	6	6	6	6	6	6	6	6	6	6	6	6	6
	Designing and Modeling 7	Block C	7	7	7	7	7	7	7	7	7	7	7	7	7	7	7	7	7
	Automation and Robotics	Block D	7	7	7	7	7	7	7	7	7	7	7	7	7	7	7	7	7
	Designing and Modeling 6	Block E	8	8	8	8	8	8	8	8	8	8	8	8	8	8	8	8	8
	Automation and Robotics	Block F	8	8	8	8	8	8	8	8	8	8	8	8	8	8	8	8	8
		Block G																	
		Block A	6	6	6	6	6	6	6	6	6	6	6	6	6	6	6	6	6
Fish Lab	Introduction to Fish Lab	Block B	6	6	6	6	6	6	6	6	6	6	6	6	6	6	6	6	6
	Introduction to Fish Lab	Block C	7	7	7	7	7	7	7	7	7	7	7	7	7	7	7	7	7
	Green Architecture	Block D																	
	Wood and Metal	Block E	8	8	8	8	8	8	8	8	8	8	8	8	8	8	8	8	8
	Green Architecture	Block F	8	8	8	8	8	8	8	8	8	8	8	8	8	8	8	8	8
Computer Science and Technology	Introduction to Computing	Block A	6	6	6	6	6	6	6	6	6	6	6	6	6	6	6	6	6
	Introduction to Computing	Block B	6	6	6	6	6	6	6	6	6	6	6	6	6	6	6	6	6
	Computer Science	Block G																	
Band/Instrumental Instruction	Introduction to Theater Arts	Block A																	
	Introduction to Theater Arts	Block B																	
	Acting 1	Block C																	
	Acting 1	Block D																	
	Acting 1	Block E																	
	Costuming	Block F																	
		Block G																	
	Music and Expression	Block A																	
	Music and Expression	Block B																	
	Music Tech 1 Composing	Block C																	
Chorus	Music Tech 1 Composing	Block D																	
	Music Tech 2 Composing	Block E																	
	Music Tech 2 Composing	Block F																	
	Guitar 1	Block G																	
		Block A																	

Culinary Lab	Courses	Semester		Semester 1															
		Term	1	2	1							2							
Gymnasium 1	Intro to Culinary, Food Safety and Science (Teegan)	Block A	8	6	6	6	6	6	6	6	6	6	6	6	6	6	6	6	6
	Intro to Culinary, Food Safety and Science	Block B	6	6	6	6	6	6	6	6	6	6	6	6	6	6	6	6	6
	Culinary/Cultural Connections	Block C	7	7	7	7	7	7	7	7	7	7	7	7	7	7	7	7	7
	Farm/Garden to Table	Block D	7	7	7	7	7	7	7	7	7	7	7	7	7	7	7	7	7
	Culinary/Cultural Connections	Block E	8	8	8	8	8	8	8	8	8	8	8	8	8	8	8	8	8
	Farm/Garden to Table	Block F	8	8	8	8	8	8	8	8	8	8	8	8	8	8	8	8	8
		Block G																	
		Block A	6	6	6	6	6	6	6	6	6	6	6	6	6	6	6	6	6
Gymnasium 2	Grade 6 Physical Education	Block B	6	6	6	6	6	6	6	6	6	6	6	6	6	6	6	6	6
	Grade 6 Physical Education	Block C	6	6	6	6	6	6	6	6	6	6	6	6	6	6	6	6	6
	Team Sports	Block D	7	7	7	7	7	7	7	7	7	7	7	7	7	7	7	7	7
	Lifetime Sports	Block E	8	8	8	8	8	8	8	8	8	8	8	8	8	8	8	8	8
	Mindful Moments	Block F	8	8	8	8	8	8	8	8	8	8	8	8	8	8	8	8	8
Gymnasium 3	Grade 6 Physical Education	Block A	6	6	6	6	6	6	6	6	6	6	6	6	6	6	6	6	6
	Grade 6 Physical Education	Block B	6	6	6	6	6	6	6	6	6	6	6	6	6	6	6	6	6
	Team Sports	Block C	7	7	7	7	7	7	7	7	7	7	7	7	7	7	7	7	7
	Lifetime Sports	Block D	7	7	7	7	7	7	7	7	7	7	7	7	7	7	7	7	7
	Mindful Moments	Block E	8	8	8	8	8	8	8	8	8	8	8	8	8	8	8	8	8
Cardio/Fitness Lab	Grade 6 Physical Education	Block A	6	6	6	6	6	6	6	6	6	6	6	6	6	6	6	6	6
	Grade 6 Physical Education	Block B	6	6	6	6	6	6	6	6	6	6	6	6	6	6	6	6	6
	Team Sports	Block C	7	7	7	7	7	7	7	7	7	7	7	7	7	7	7	7	7
	Lifetime Sports	Block D	7	7	7	7	7	7	7	7	7	7	7	7	7	7	7	7	7
	Mindful Moments	Block E	8	8	8	8	8	8	8	8	8	8	8	8	8	8	8	8	8

Day	Semester 1													
	1							2						
	1	2	3	4	5	6	7	1	2	3	4	5	6	7
Block A	17	17	17	17	17	17	17	17	17	17	17	17	17	17
Block B	18	18	18	18	18	18	18	18	18	18	18	18	18	18
Block C	20	19	20	19	20	19	20	19	20	19	20	19	20	19
Block D	17	17	17	17	17	17	17	17	17	17	17	17	17	17
Block E	17	19	17	19	17	19	18	18	18	18	18	18	18	18
Block F	17	16	17	16	17	16	16	17	16	17	16	17	16	17
Block G	0	0	0	0	0	0	0	0	0	0	0	0	0	0

Semester	Semester 1													
	1							2						
	1	2	3	4	5	6	7	1	2	3	4	5	6	7
Block A	5	5	5	5	5	5	5	5	5	5	5	5	5	5
Block B	5	5	5	5	5	5	5	5	5	5	5	5	5	5
Block C	5	4	5	4	5	4	5	4	5	4	5	4	5	4
Block D	4	4	4	4	4	4	4	4	4	4	4	4	4	4

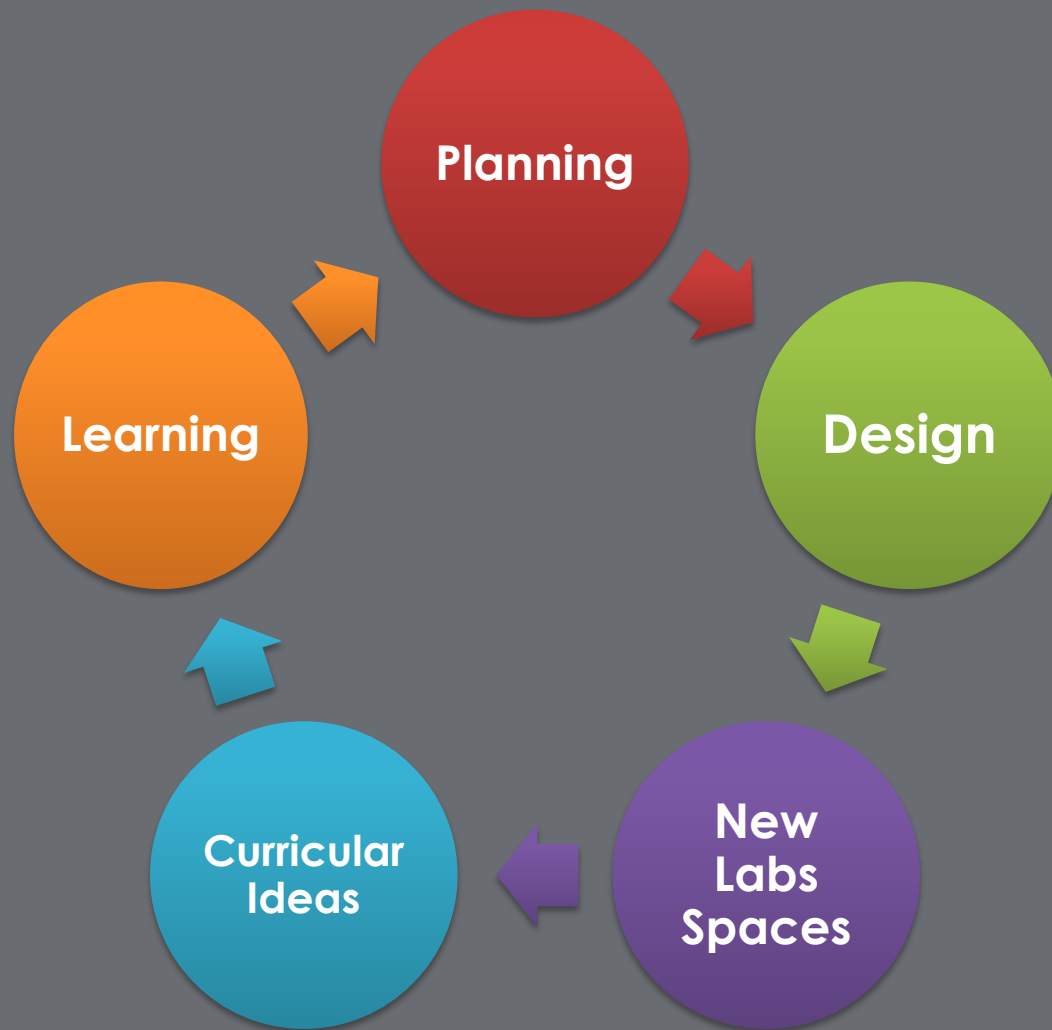

Questions

