



**THIRD FLOOR PLAN** 

- 1 Small Instruction Space
- 2 Student Flex Area
- 3 Teacher Planning Office
- 4 Learning Resource Center
- 5 Green Roof
- 6 Photovoltaic Panel Array

**SIXTH FLOOR PLAN** 

- 1 Communications Computer Lab
- 2 Audio Recording
- 3 Graphic Arts
- 4 Dark Room
- 5 Photography
- 6 2D Art
- 7 Student Gallery
- 8 Student Flex Area
- 9 Teacher Planning Office
- 10 Science Lab
- 11 Prep Room
- 12 3D Art





# Lincoln High School

PORTLAND PUBLIC SCHOOLS

**“What I love about this school is that the project was designed to support academic innovations, athletics, and the arts equally. Bora treated every space like an educational opportunity.”** – Peyton Chapman, Principal

At six stories high, Lincoln High School is the first high-rise high school in the state of Oregon, and the only school subject to Portland’s demanding Central City Design Guidelines. Bora worked closely with a variety of stakeholders to develop a design that physically reconnects the divided Goose Hollow neighborhood and provides a uniquely active street-level presence.

**Student Movement, Activity + Health.** Inviting and prominent exterior glass-wrapped stairs emphasize the school’s vertical nature while projecting a sense of movement and energy outward. Flexible learning spaces on every floor cultivate collaboration, while expansive windows with east/west views strengthen students’ connections to the urban surroundings and the hills beyond.

**Robust Community Engagement.** By encouraging a diversity of stakeholder voices to guide our design — including a student-led Equity/Justice/Inclusion Committee — we saw how communities influence a successful process, and how community allyship is critical. Key outcomes include a new pedestrian plaza in the vacant 17th Street and a student-focused multicultural center on the ground floor.

**Resiliency + Sustainability.** The new school employs a sophisticated steel-moment frame structure and sub-grade reinforcement to achieve a higher level of resistance to earthquakes. Building infrastructure is supported by numerous back-up systems for power and water. Solar panels and green roofs have been integrated into the building to reduce operational costs and to fulfill the District’s sustainability goals.



### FIRST FLOOR PLAN

- 1 Media Center
- 2 Reception and Lobby
- 3 Makerspace
- 4 Blackbox
- 5 Student Commons
- 6 Construction CTE
- 7 Product Design
- 8 Theater
- 9 Choir
- 10 Servery
- 11 Band
- 12 Wrestling & Cheerleading

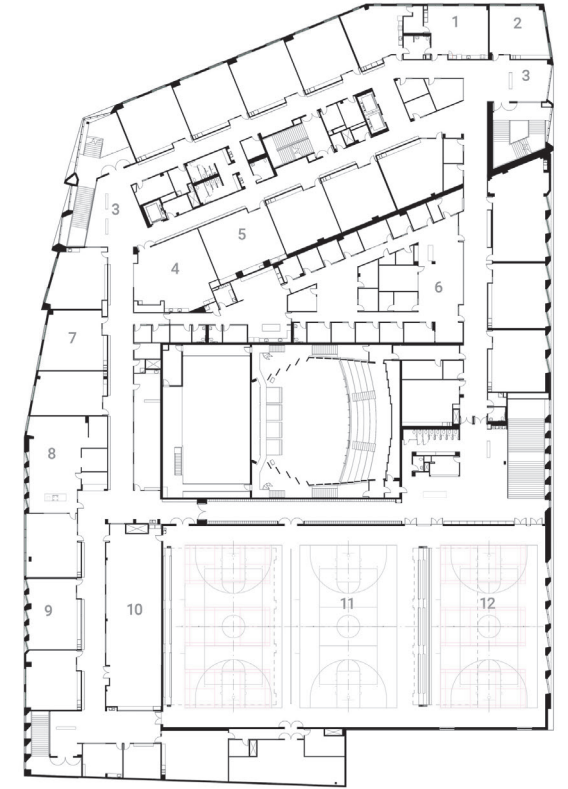

### SECOND FLOOR PLAN

- 1 Special Education Suite
- 2 Learning Resource Center
- 3 Student Flex Area
- 4 Robotics Classroom
- 5 Computer Lab
- 6 Career Center
- 7 Business Classroom
- 8 Culinary Arts CTE Kitchen
- 9 Health Classroom
- 10 Weightlifting
- 11 Main Gym
- 12 Auxiliary Gym

#### PROJECT DATA

**Size**  
289,000 SF

**Number of Students**  
1,600 (Grades 9-12)

**Delivery Method**  
CM-GC

**Completion**  
2023

#### TEAM MEMBERS

**Owner**  
Portland Public Schools

**Architect**  
Bora Architecture & Interiors

**General Contractor**  
Hoffman + Pacifickmark

**MEP**  
Interface

**Structural Engineer**  
KPFF

**Civil Engineer**  
KPFF

**Landscape Architecture**  
Mayer / Reed

**Theater Consultant**  
The Shalleck Collaborative