

The Power of Partnership in Specialized School Design

A4LE LearningSCAPES 2024

Elizabeth Dickey, EDC

Chad Johnson, Page

Charlsi Kratina, BCDM

AJ Sivakumar, DLR Group



Introductions



Presenters



Elizabeth Dickey
Former Principal of
the Rosedale School



Chad Johnson
Architectural Design of
the Rosedale School



Charlsi Kratina
Interior Design of the
Rosedale School



AJ Sivakumar
Planning for the
Rosedale School



AECOM



Page/



 **DLRGROUP**





What is your professional role?



Educator

0

Design Professional
(Architect/Designer/Engineer)

0

Researcher

0

Administrator



Join at menti.com | use code **8468 5729**

What brought you to this presentation?

All responses to your question will be shown here

Each response can be up to 200 characters long





Pop Culture Partnerships

Pop Culture Partnerships



Unprecedented Partnerships



History and Context

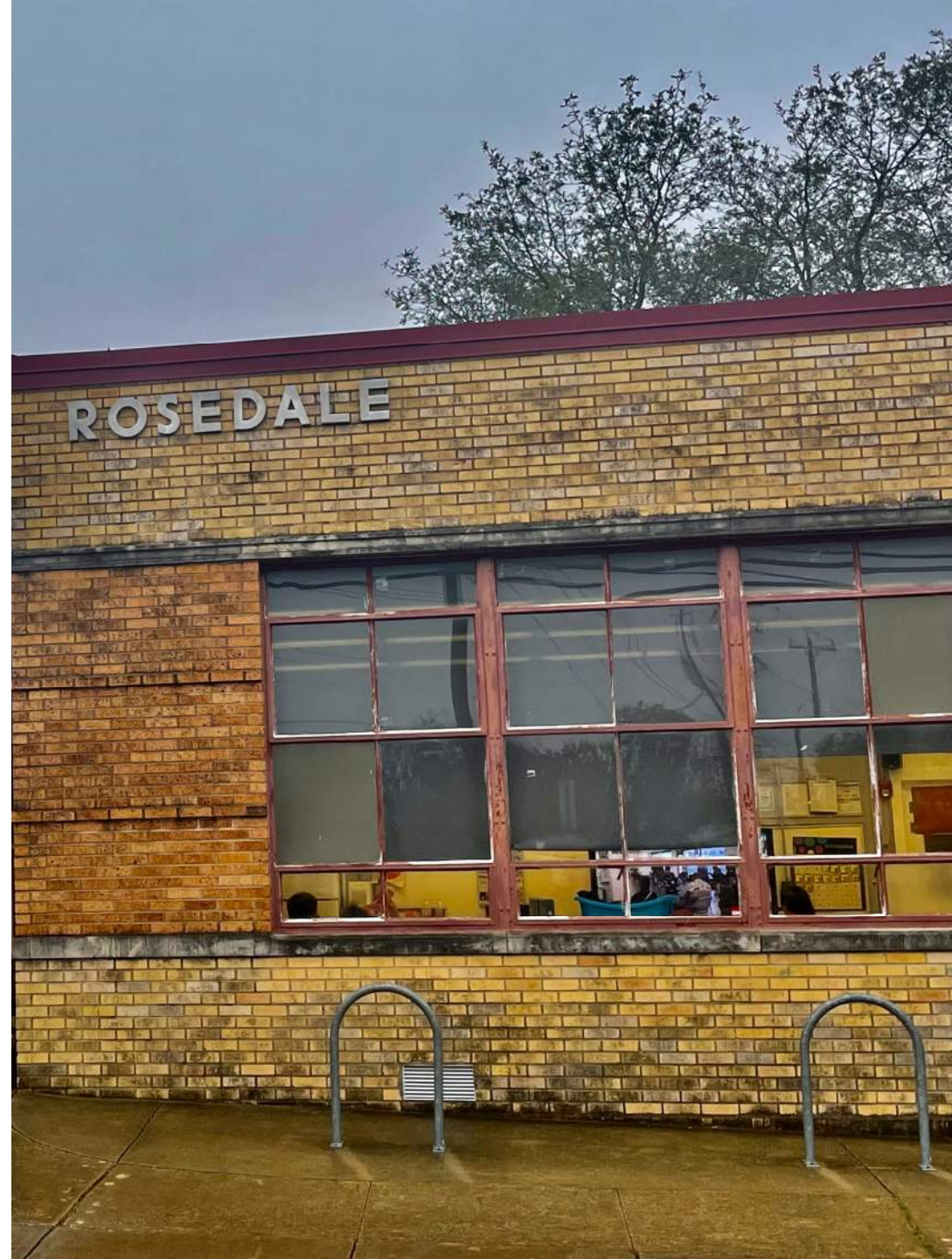



ROSEDALE SCHOOL AT READ PRE-K SCHOOL CAMPUS FACILITY PROJECT SHEET



Information for Future Location at the Read Pre-K School Campus

2608 Rich Creek
Austin, TX 78757

Building Area: 37,232 Square Feet
Site: 10 Acres

Date of First Construction: 1961
Planned Capacity: N/A

About the Campus

Rosedale School offers tailored educational opportunities and quality instruction for children with severe special needs, including children who are medically fragile or need intensive behavioral support. The campus also houses the Transition to Life in the Community program to prepare students for postsecondary life.

For more detailed information about the district's long-term Facility Master Plan and recommendations for this facility, please visit www.aisdfuture.com.

Proposed Projects

- Replacement School: Construction of a New Facility at the Read Campus
- New Construction and Design Based on the New AISD Educational Specifications to Create a New State-of-the-Art Facility
- Technology: Computer Lab Improvements
- Technology: Student Mobile Computers
- Technology: Teacher Computers

Read Pre-K School Campus Scores

Facility Condition Assessment (FCA)

District Average - Special Campus	Before Improvements	After Improvements
33	23	90+
Fail < 30	Poor 30 - 49	Average 50 - 69
	Good 70 - 89	Excellent 90 - 100

Educational Suitability Assessment (ESA)

District Average - Special Campus	Before Improvements	After Improvements
37	60	90+
Fail 20 - 35	Poor 36 - 50	Average 51 - 65
	Good 66 - 80	Excellent 81 - 100

Estimated Cost of Proposed Projects

\$40,092,000

Projects may include funding from additional sources.

The FCA and ESA scores are a representation of the condition of the facility only, not of the school's academic performance.



Shelby Dotin

Teacher, Rosedale School

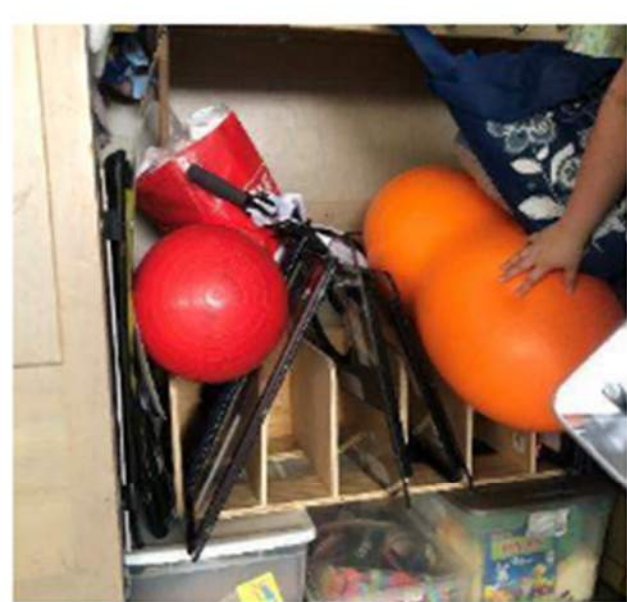

Members Open Forum

Settings

Community Home

Discussion 550

Library 43

Events 0

Members 5.4K

← Back to discussions

[Expand all](#) | [Collapse all](#)

sort by thread ▾

Special Needs School Examples for Students who are Medical Fragile with Multiple Disabilities

Follow ☆

9. RE: Special Needs School Examples for Students who are Medical Fragile with Multiple Disabilities

0 Recommend



[Robert Mabrey](#)
REPP

Actions ▾

Posted 12-13-2019 07:35

Reply ▾

The email string below referenced the J.P. Lord School in Omaha as well as the Rosedale School in Austin, Texas. BCDM Architects had the privilege of being the architect for the JP Lord School. During the construction phase of JP Lord, Jim Brady from Page Architects in Austin posted on this forum wanting model facilities that dealt with medically fragile students. I responded to Jim's post and shared the JP Lord Ed Spec document that BCDM had prepared. One of Jim's colleagues at Page, Chad Johnson, has a special needs son who attends Rosedale School. Together they used the JP Lord Ed Spec to further enlighten and inform the Austin School District so that they would allocate proper resources to the proposed Rosedale project. The bond issue passed and it was time to move forward with the project. The district along with their program management team (AECOM & DLR Group) went to Omaha and visited JP Lord School (as well as other schools in other parts of the country). DLR Group prepared a bridging document that had quite a few photos of JP Lord as examples of features that Rosedale wanted to emulate in their new school. When it came time for architect selection, Page asked BCDM to join their team which we did. We completed and submitted Schematic Design this week. Rosedale has medically fragile students like JP Lord school but it also has students classified as social & behavior disorder (75% of which are on the autism scale) as well as a transition program for students ages 18-22 who will transition to life in the community. A recent exciting addition is adding a private clinic as a tenant in the school. The clinic specializes in serving medically fragile students.

Advocating for More

Special Needs Schools - Case Studies

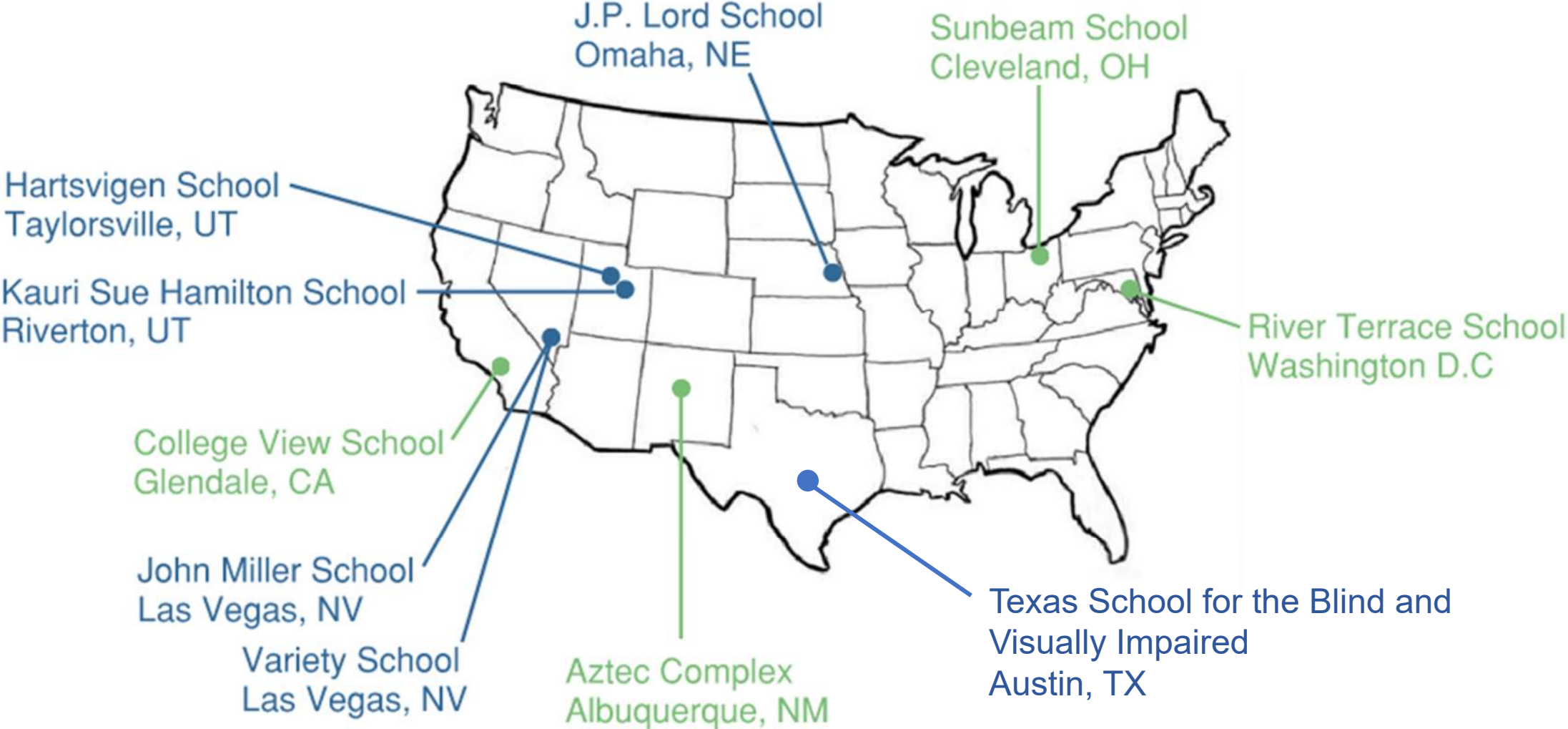

Planning



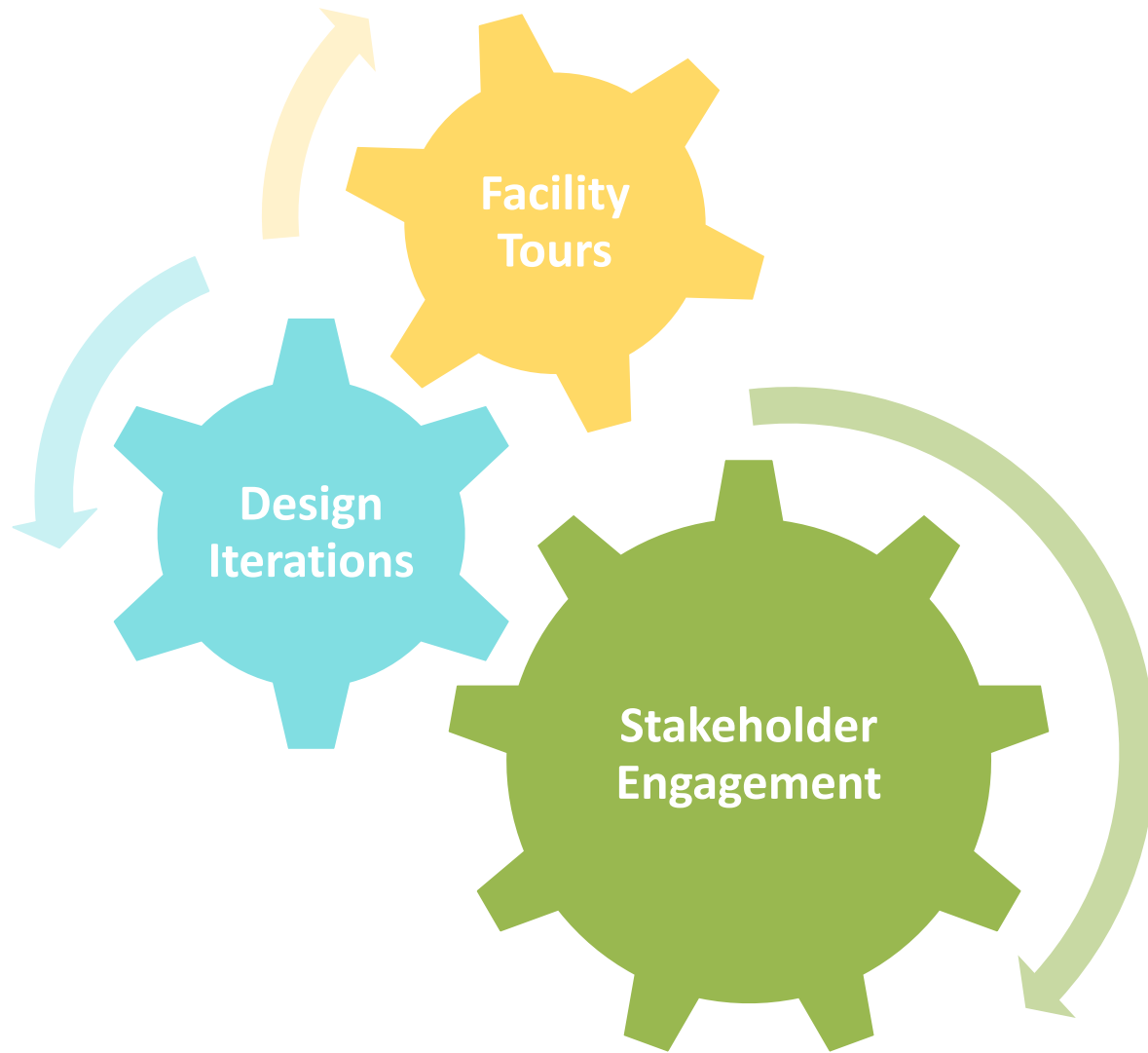





*“Supporting the diverse needs of medically fragile
and those with extreme behavioral challenges
lacks a specific formula or solution.”*

- Karen Russell, VS America

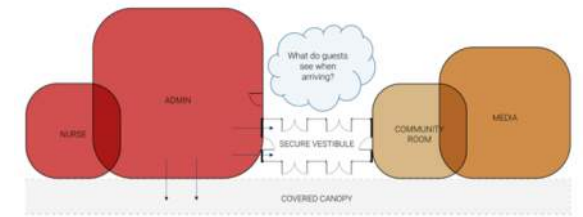
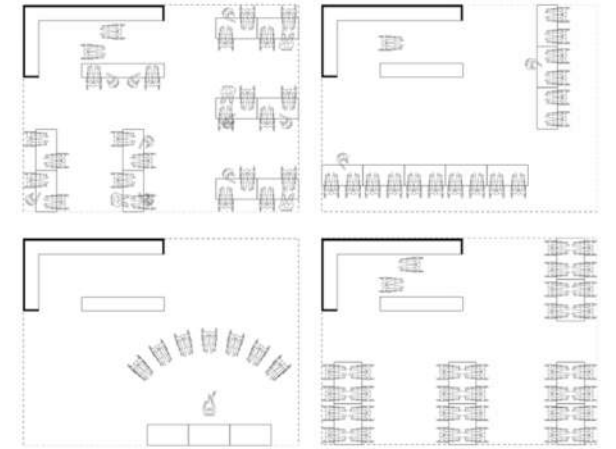
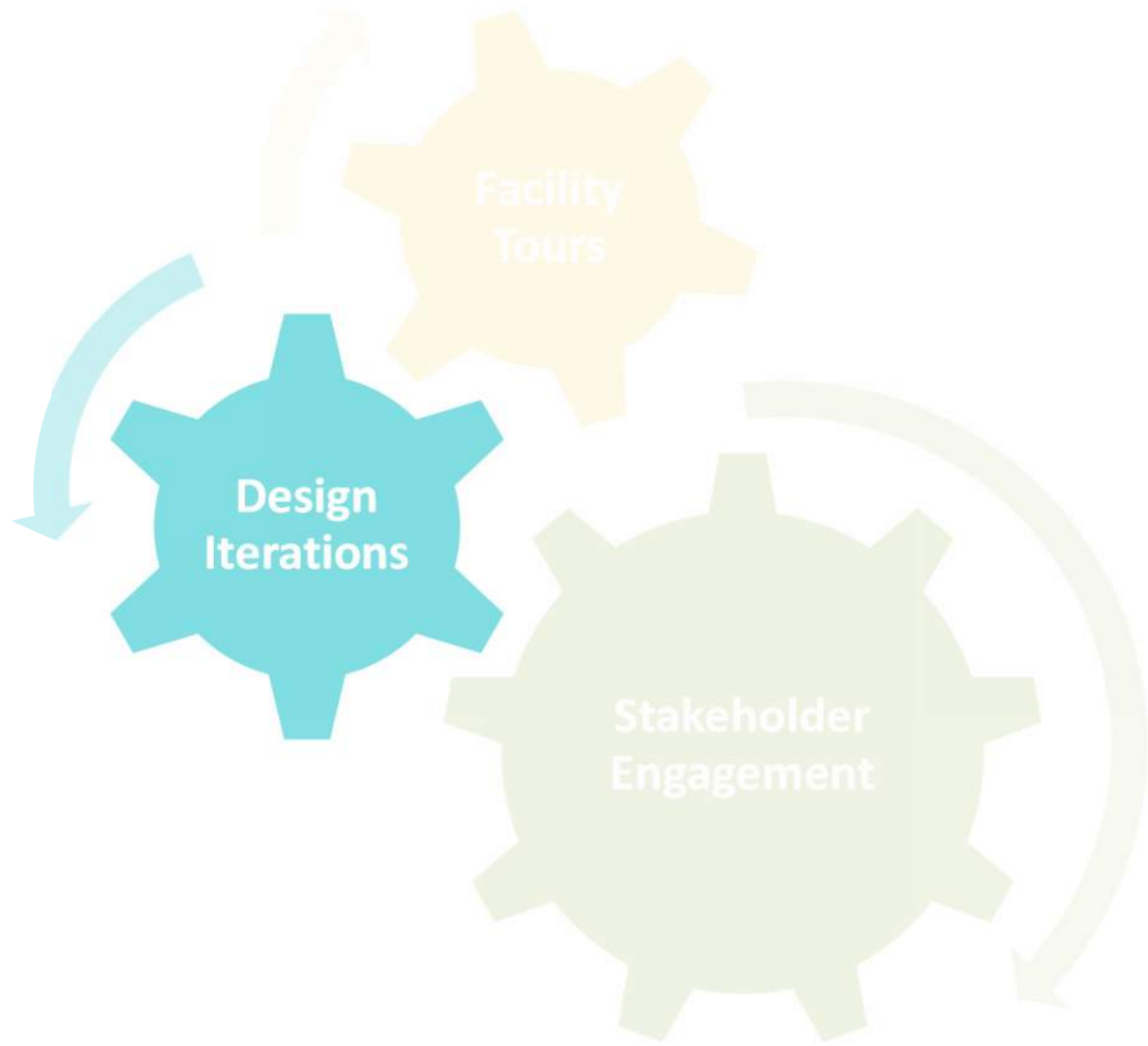

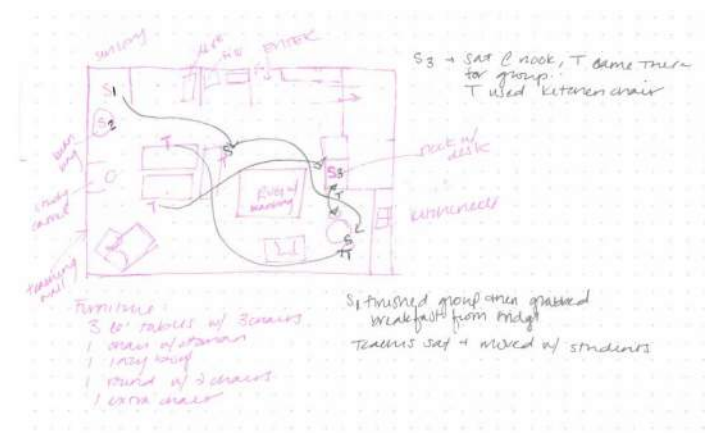
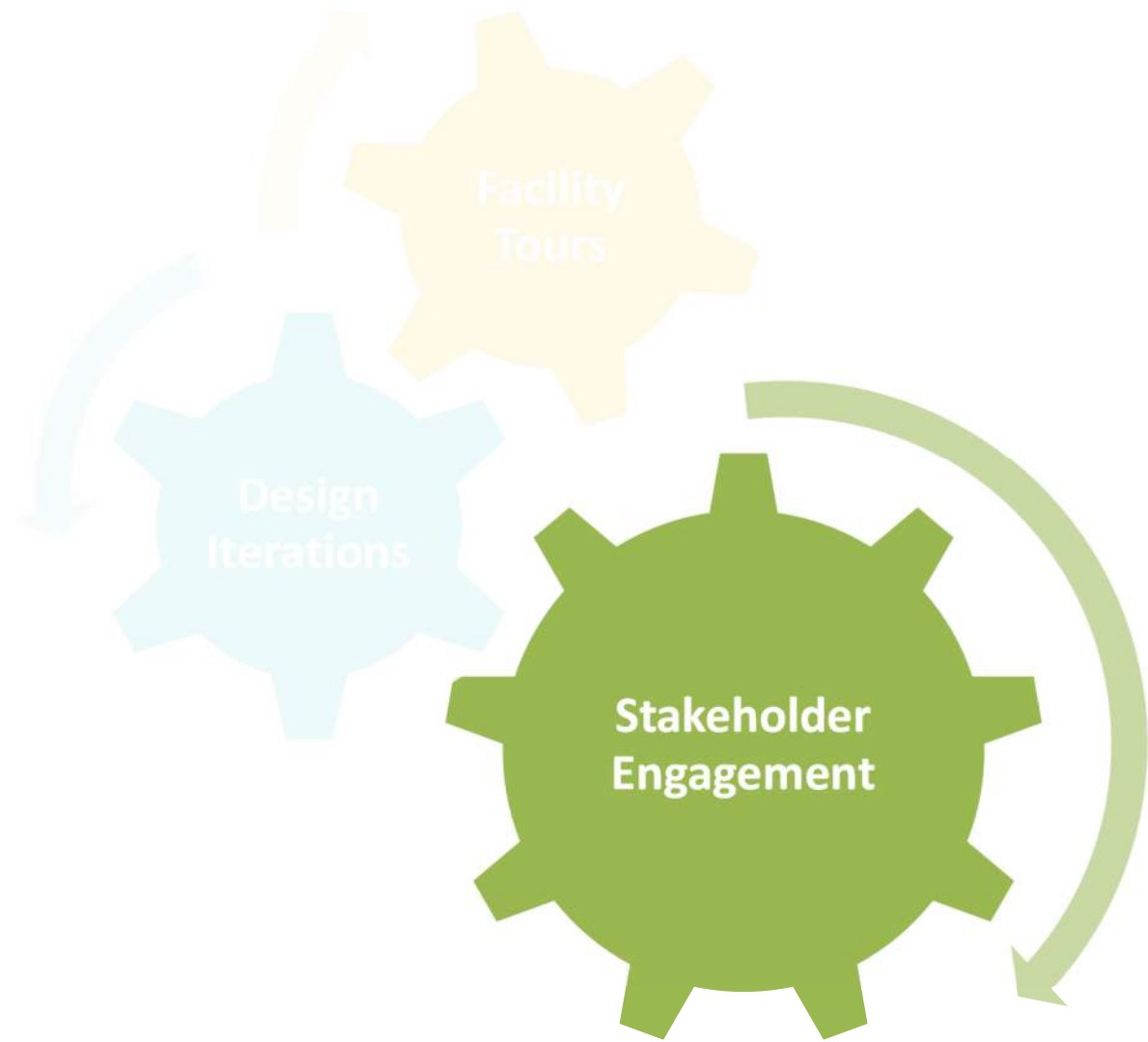

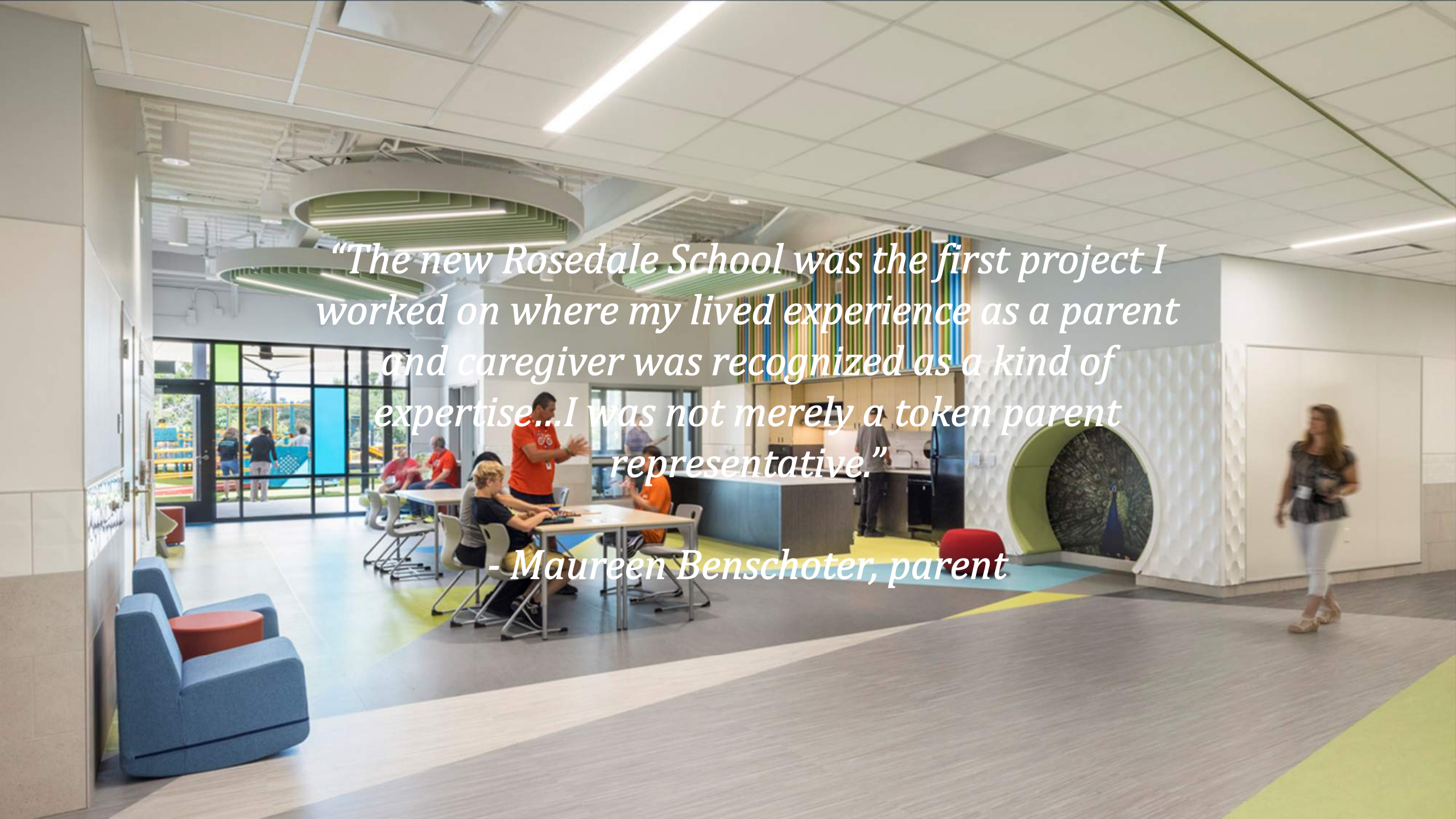
A wide-angle photograph of a modern school interior. The space is bright and open, with a high ceiling featuring recessed lighting and large circular light fixtures. In the foreground, there are blue armchairs and a red ottoman. In the middle ground, several people are seated at tables, some working on laptops. A man in a red shirt is standing and talking to a group. In the background, there is a kitchen area with a person working at a counter. To the right, a woman is walking. A large window on the left side of the image shows an outdoor playground area. The floor is a mix of grey, blue, and green tiles. The overall atmosphere is collaborative and modern.

“The new Rosedale School was the first project I worked on where my lived experience as a parent and caregiver was recognized as a kind of expertise...I was not merely a token parent representative.”

- Maureen Benschoter, parent

"The new Rosedale School should reflect the people and community it serves - a loving place for learning and growth that embraces togetherness."

- Rosedale CAT

Peace Centers



What if...we need to invent new space types to reflect our shared goals for the new Rosedale School?

The Living Room

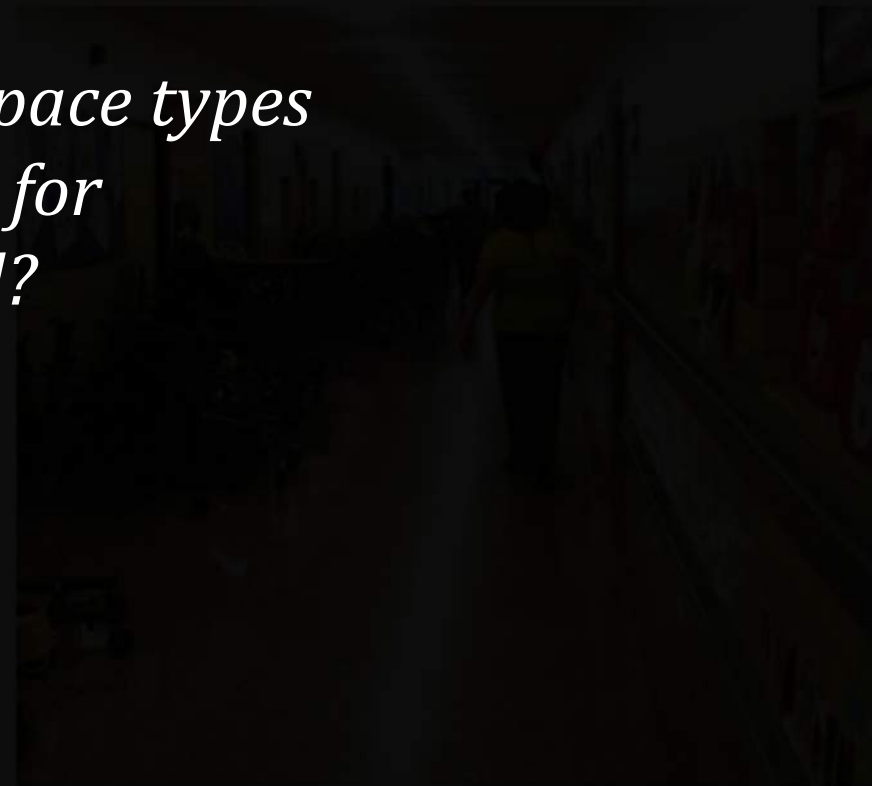



*Minimizing 90° outside
corners*

*How can we...expand how we think about
technical design requirements to encourage
intentionally inclusive design?*

*Centering togetherness
when sizing corridors*



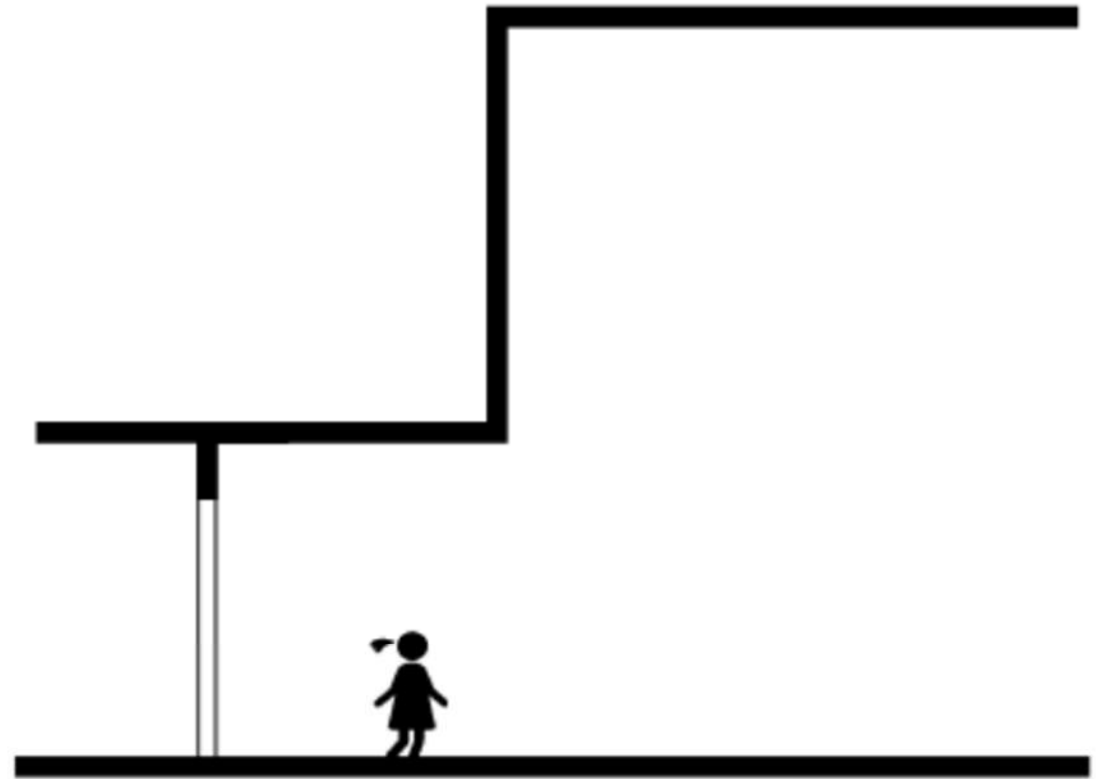
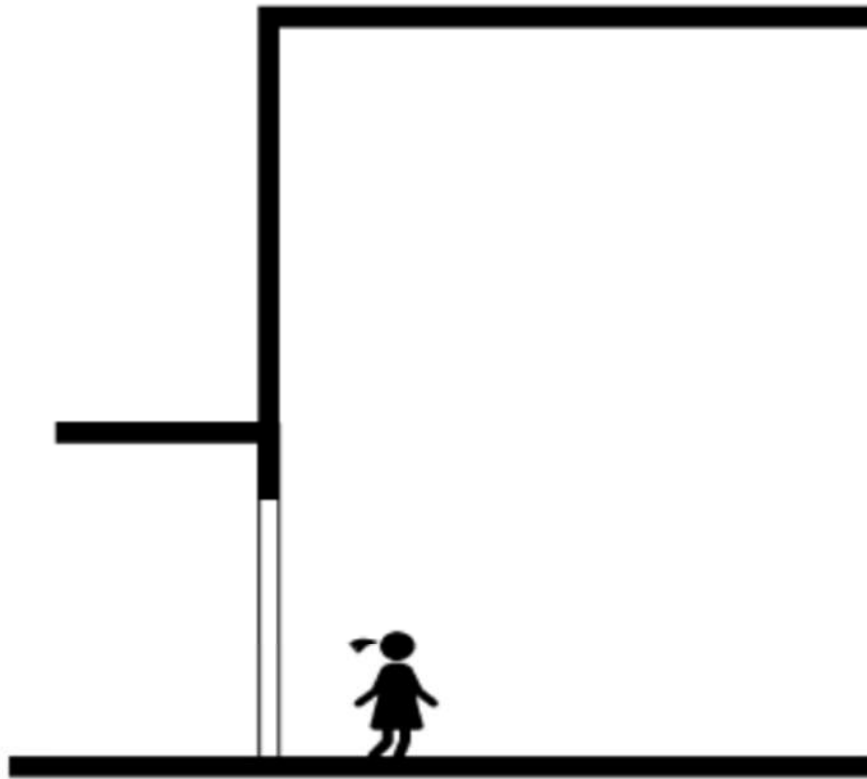

Provide transitional zones for expectation when moving from low to high ceiling areas



AUSTIN

Neighbors split over transformation of AISD building with zoning change

By Andrew Brown
Published: Jan 12, 2019, 7:05 AM CST
Updated: Jan 12, 2019, 7:05 AM CST



I wonder if...there are other partners who can help us create a transformational place?

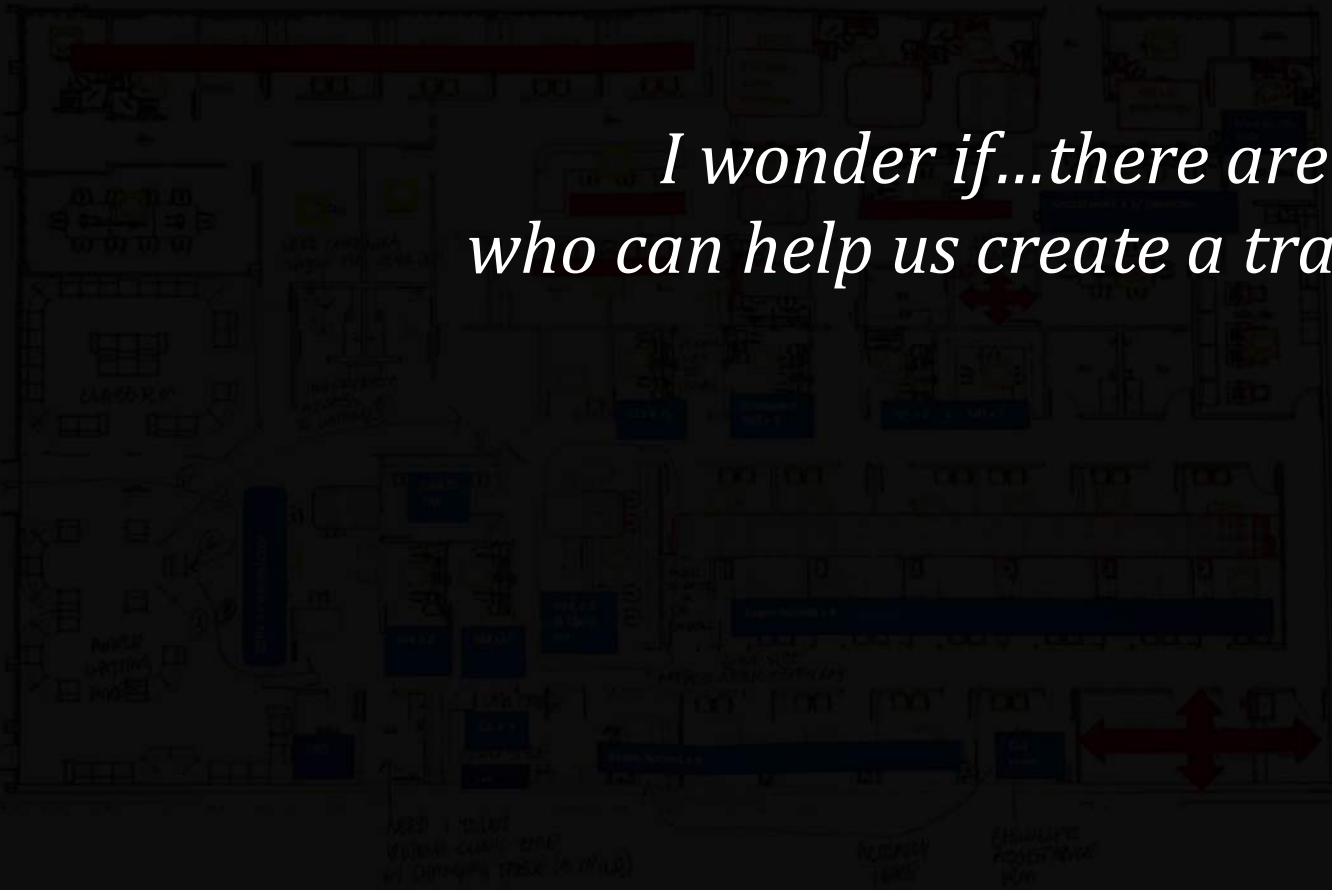

Space Name	Qty	Capacity	Notes
Reception			
Waiting Room	1		Current space is more than adequate
	5		5 customer service representatives
			Counseling, Social Worker, Dietician, RN, Neuropsychology, Psychiatry Soft chairs. Could utilize intake/wellness when those are vacant. 1-2 rooms (this is an area of flex)
Consultation Rooms	2		
			modular, also function as a room to bring in all patients with similar issue for specialist visits. Would then wait in this space while each goes and meets the Specialist 1:1
Conference Room	1	8-10	
Exam/Consult Rooms			1 for each provider, meant to support large group, support discussion around specific cases. Want 3-4 big rooms
Intake/Wellness	4		accommodate dehydration, have hospital bed + room for personnel, same size of intake/wellness
Infusion/Longer Stay	1		slightly bigger than what we see on current; need to ensure wheelchair clearance
Acute Exam Rooms	4		

Design



Human-Centric Design Process

Multi-Sensory Design



Inclusive Design



Biophilic Design



Placemaking



Site Planning + Building Organization



BUILDING IN A PARK

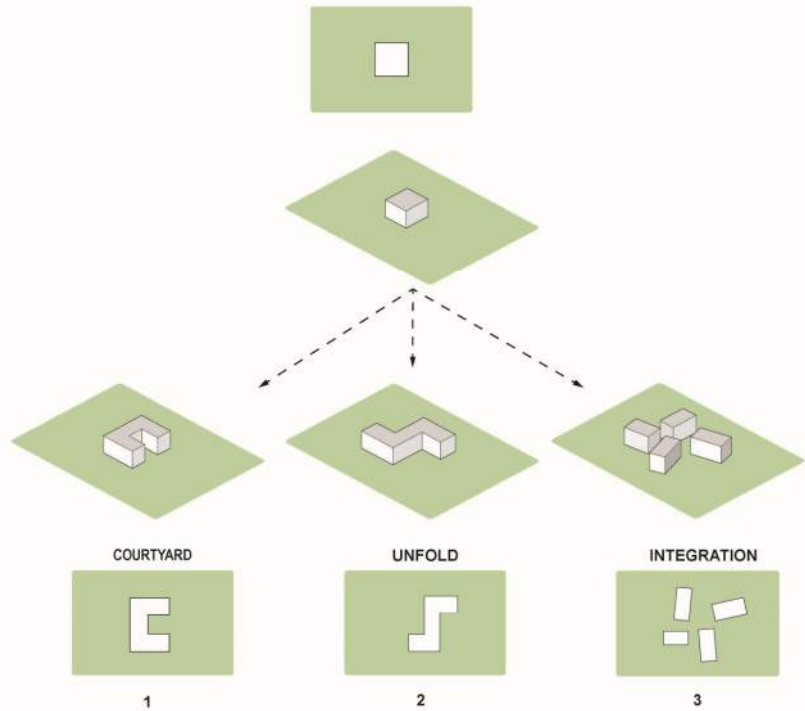

SOUTH CONGRESS



ZILKER PARK



CAPITOL

BUILDING IN A PARK

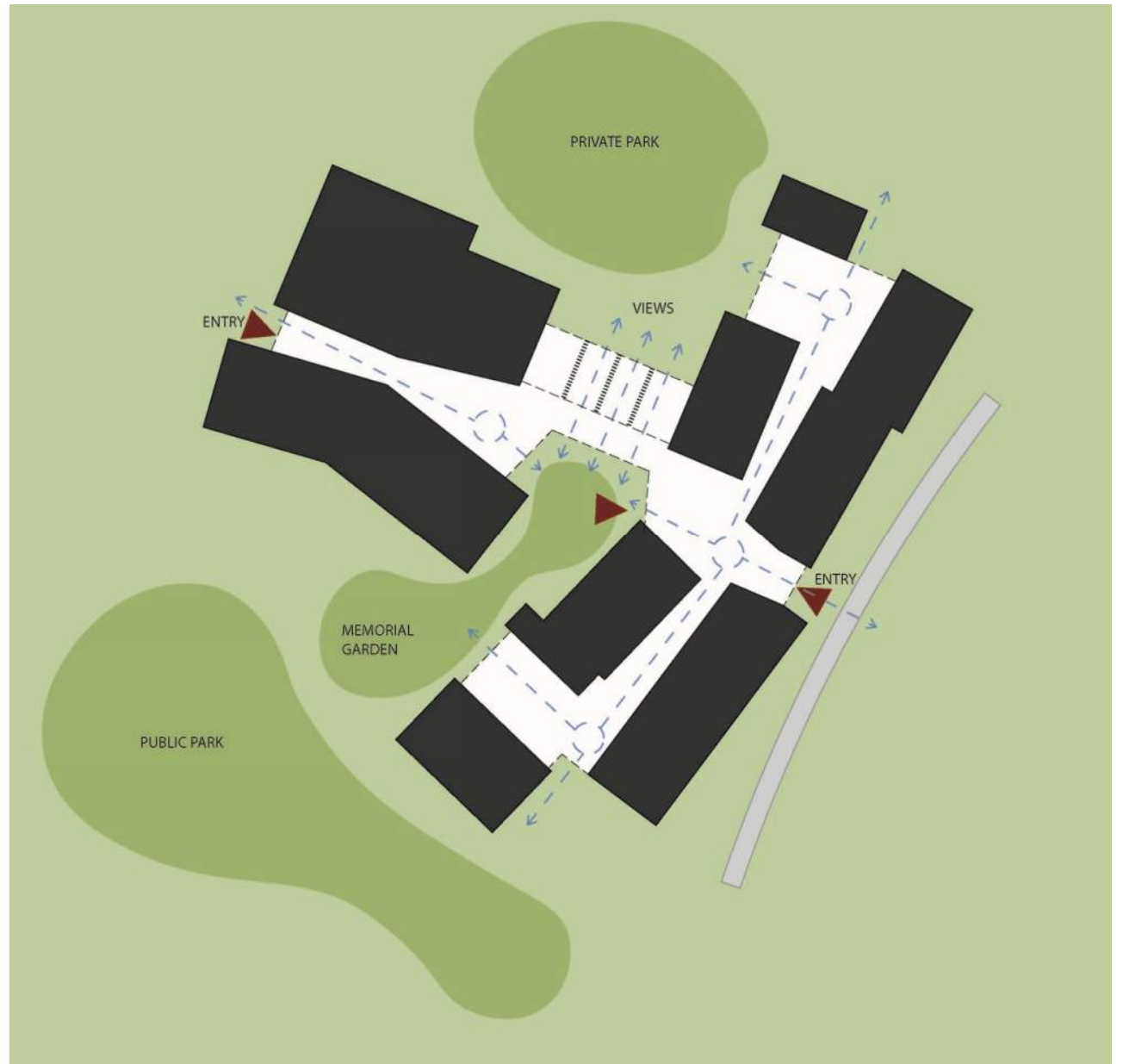



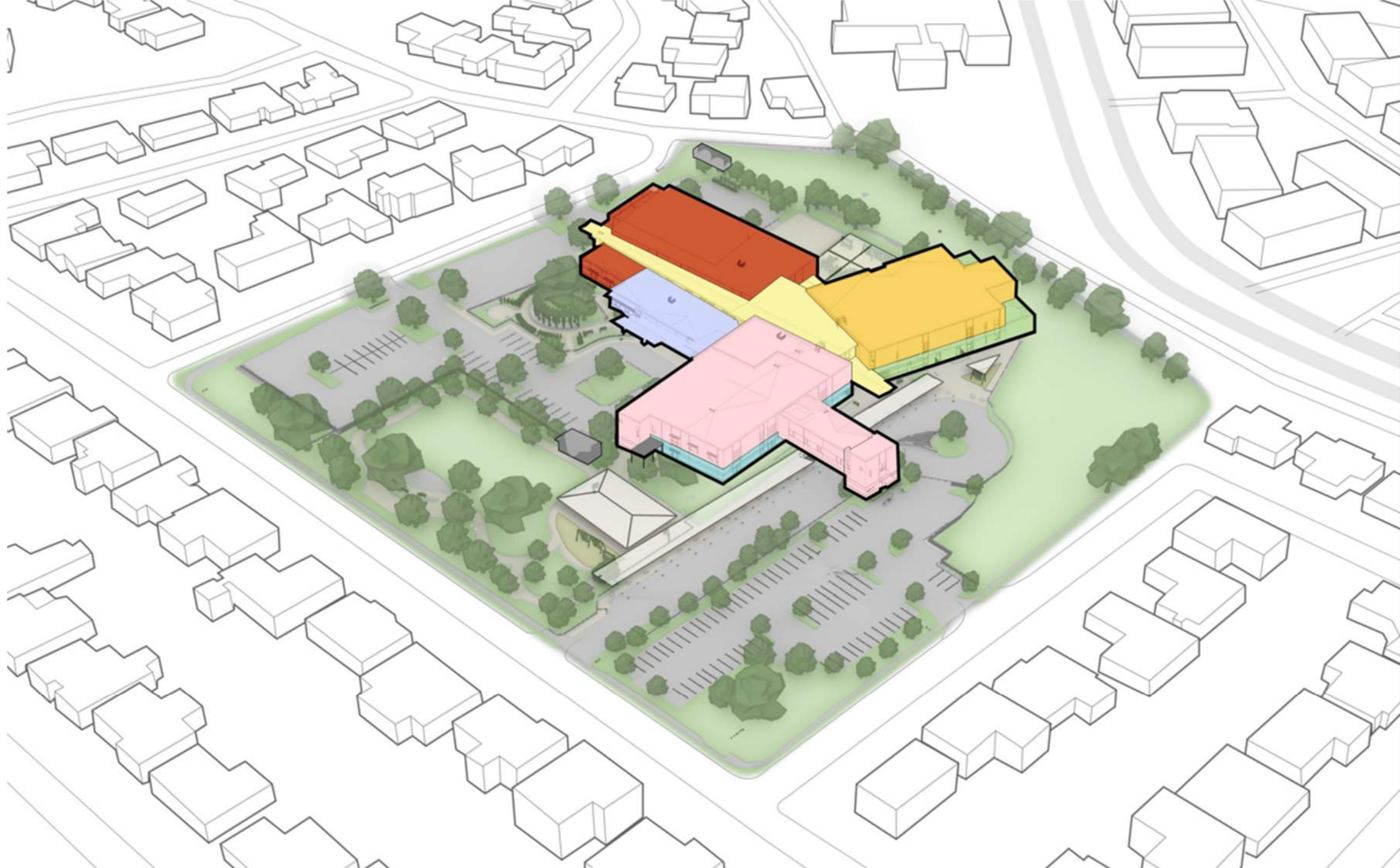

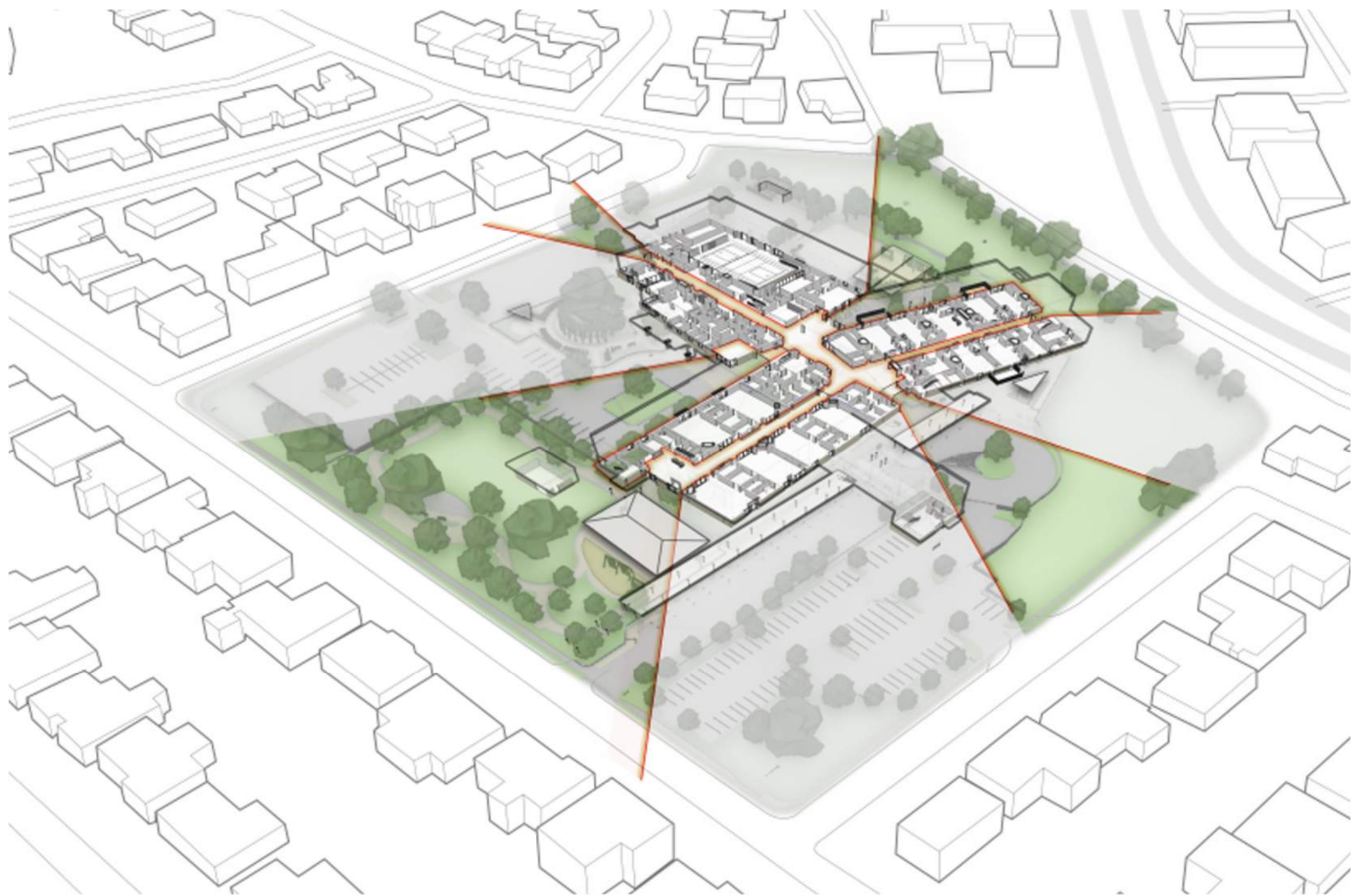

First Floor Plan





LEVEL 01

- COMMON AREAS
- ADMIN
- MEDICALLY FRAGILE
- SOCIAL BEHAVIORAL
- CIRCULATION
- CLINIC

LEVEL 02

- CLINIC
- ADMIN
- TLC

Second Floor Plan

CLINIC IMAGE/IMAGES?





“The Rosedale project took everything about human-centric design and designing for well-being combined with parent and community engagement and put it all into a package that hits every note.”

*Stephanie Kingsnorth, AIA
AIA Austin Design Award Juror*

Multi-Sensory Wayfinding





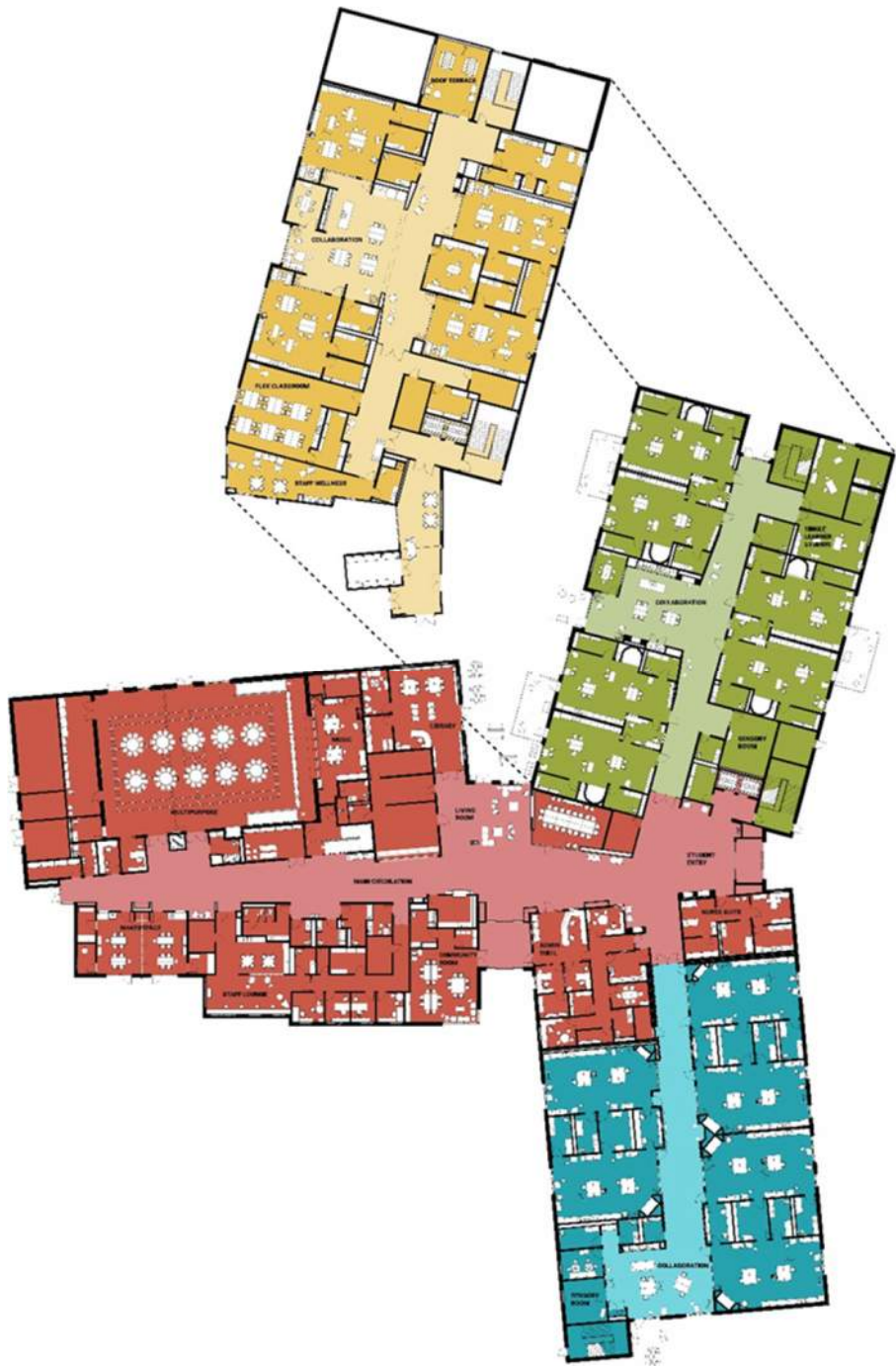



Living Room





Neighborhoods





"The cohesiveness of the planning team was essential to producing functional, inclusive environments while keeping it simple, adaptive and agile."

- Karen Russell, VS America

Peace Center





Student Lift

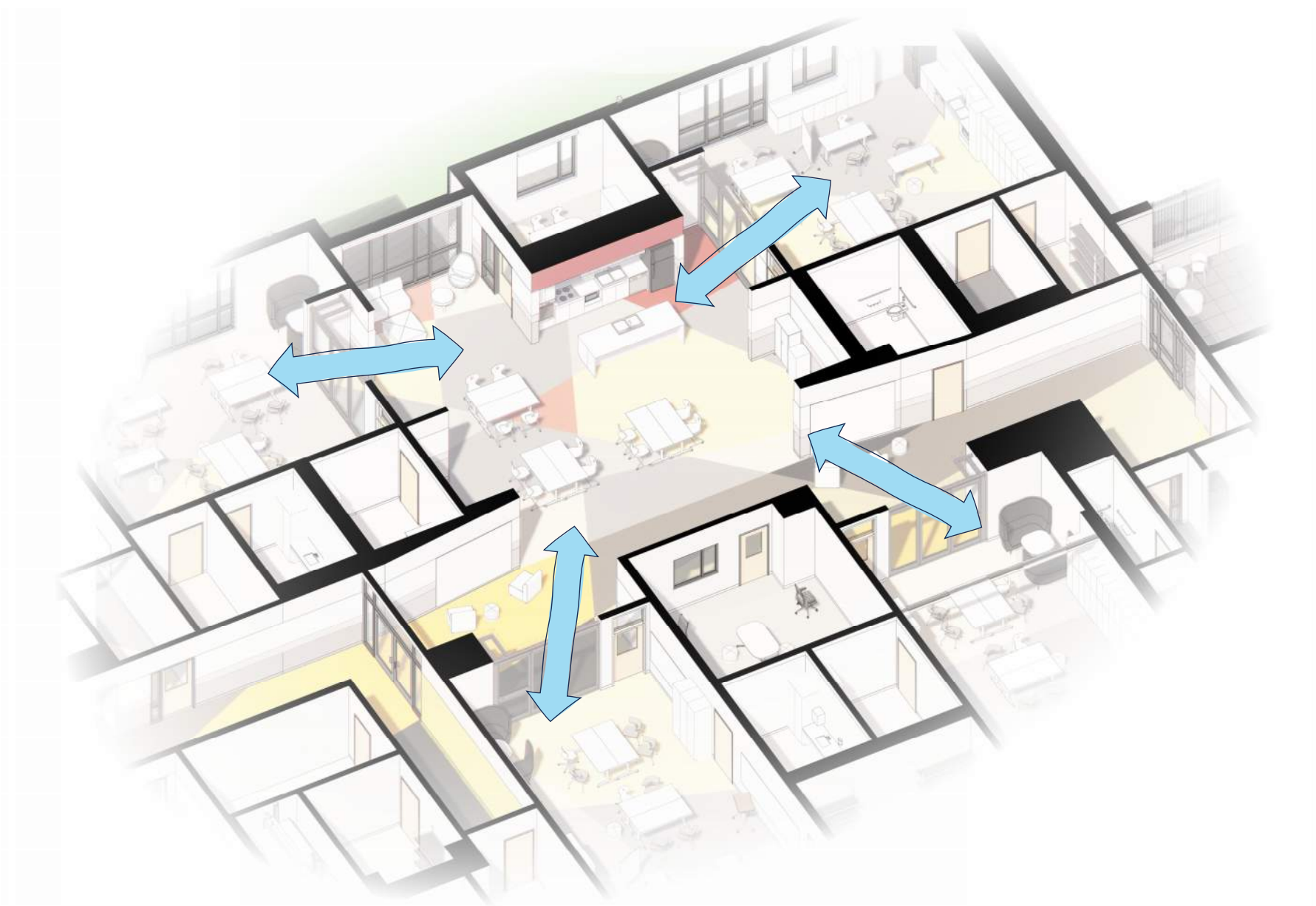

Connection to Studio



Security Grille



Conversation Nooks









A-3







"The team understood the immense benefits of providing independence and choice through sensory exploration to cultivate an environment focused on every child's well being."

- Crystal Paulitzki, Flaghouse

Outcomes







Community Impact



Part II

Universal Design



The Rosedale School Commons: different flooring materials assist with wayfinding, the space has natural daylighting, a variety of finishes with different colors, textures and patterns provides interest, the open double-height space offers visibility to other areas of the building.

"The team realized over the life of this project that everything we were proposing to implement at Rosedale -- from improved air filtration systems to better acoustic treatments to individual niches for learning and socializing -- that every student could benefit from these approaches."

- Taryn Kinney, formerly DLR Group





Activity

